

LEGEND

-  PAVEMENT REMOVAL
-  VALLEY GUTTER REMOVAL
-  ASPHALT DRIVEWAY REMOVAL
-  CONCRETE DRIVEWAY REMOVAL
-  BRICK DRIVEWAY REMOVAL
-  MEDIAN ISLAND REMOVAL
-  SEDIMENT CONTROL FENCE

NOTES:

1. CONTRACTOR WILL BE REQUIRED TO PROTECT PALM TREES SHOWN TO REMAIN.
2. APPLY SEEDING TO DISTURBED AREAS WITHIN ROW. SEEDING SHALL BE CONSIDERED SUBSIDIARY TO PERTINENT ITEMS.
3. EROSION CONTROL DEVICES SHOWN SHALL BE CONSIDERED SUBSIDIARY TO PERTINENT ITEMS.
4. INSTALL SEDIMENT CONTROL FENCE IN DITCHES LOCATED ALONG THE CROSS STREETS OF GULF BLVD.
5. CONTRACTOR TO REMOVE EXISTING STRIPING ON EAST DRIVEWAYS BY SAND BLASTING OR OTHER METHOD OF REMOVAL TO BE APPROVED BY ENGINEER. THIS SHALL BE CONSIDERED SUBSIDIARY TO PERTINENT ITEMS.
6. BURIED UTILITIES EXIST WITHIN CORRIDOR. CONTRACTOR TO LOCATE UTILITIES PRIOR TO CONSTRUCTION.

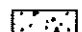
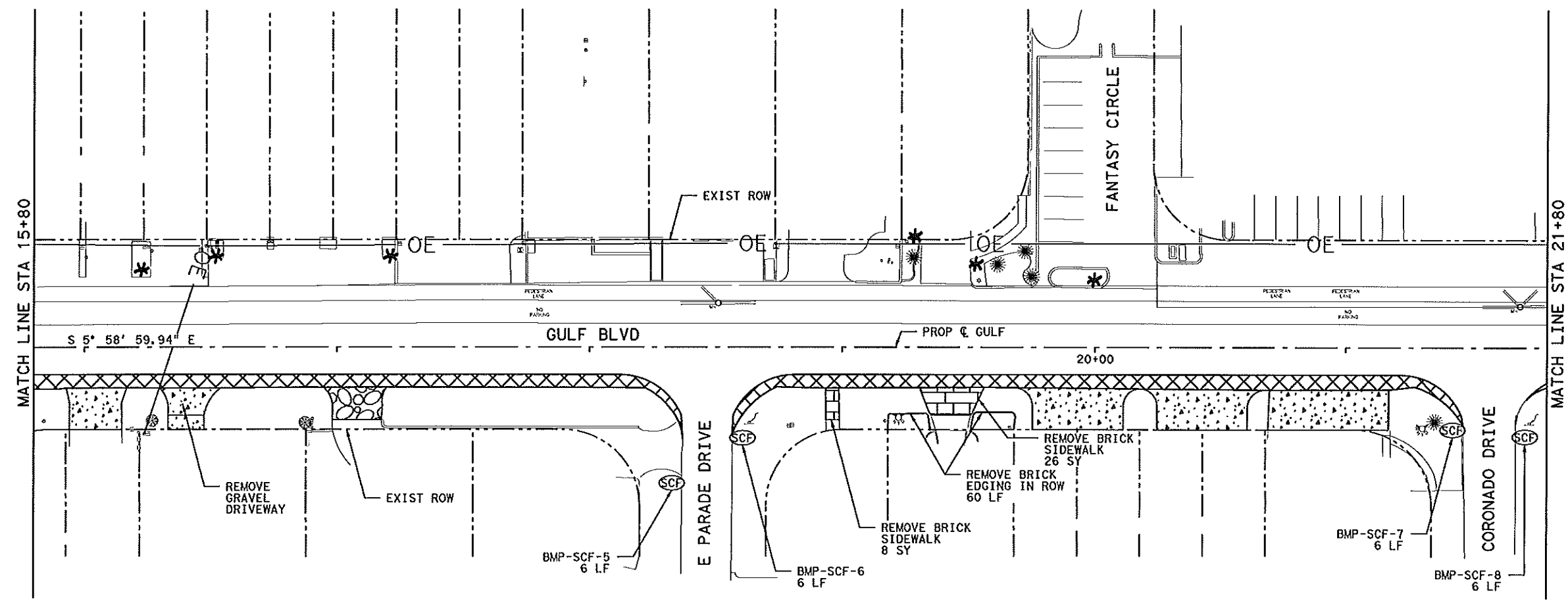
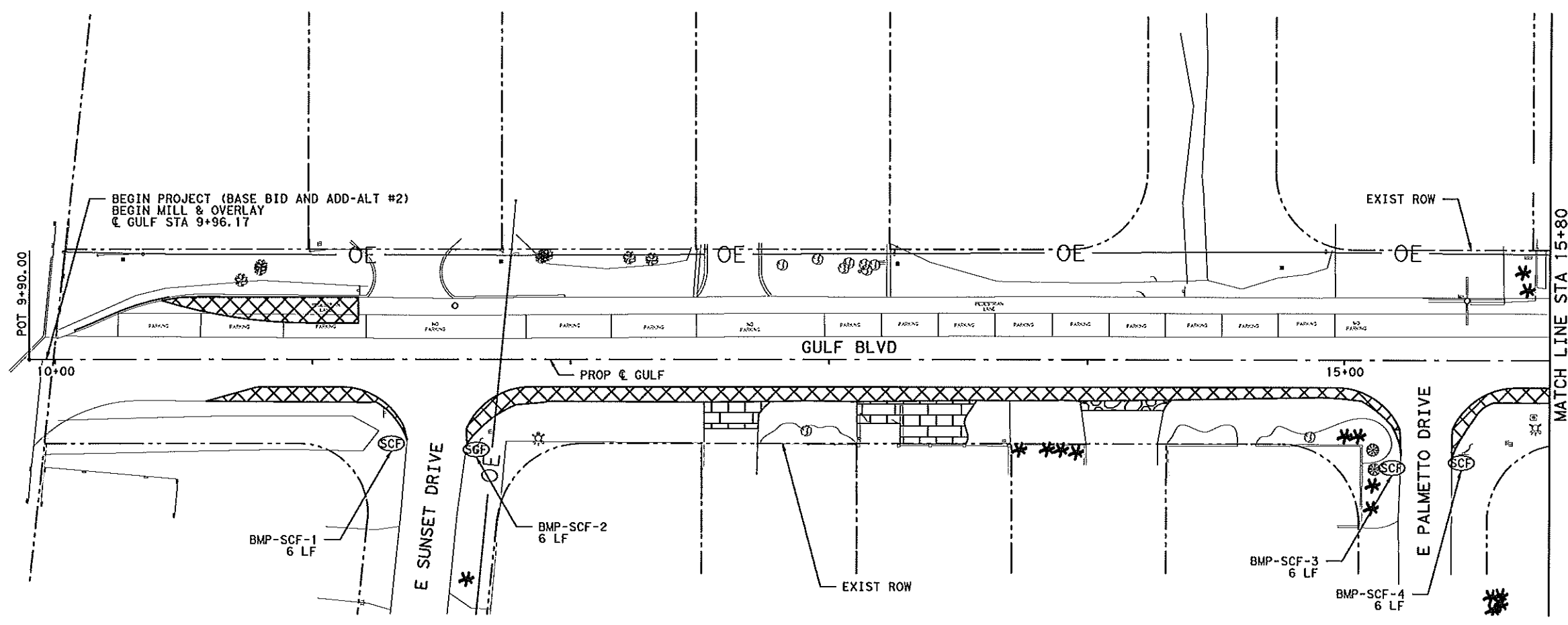
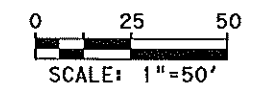

7/3/14



Kimley»Horn

South Padre ISLAND

EROSION CONTROL PLAN AND REMOVAL LAYOUT

GULF BLVD IMPROVEMENTS

SHEET 1 OF 4

SCALE	PROJECT NO.	SHEET NO.
1" = 50'		4

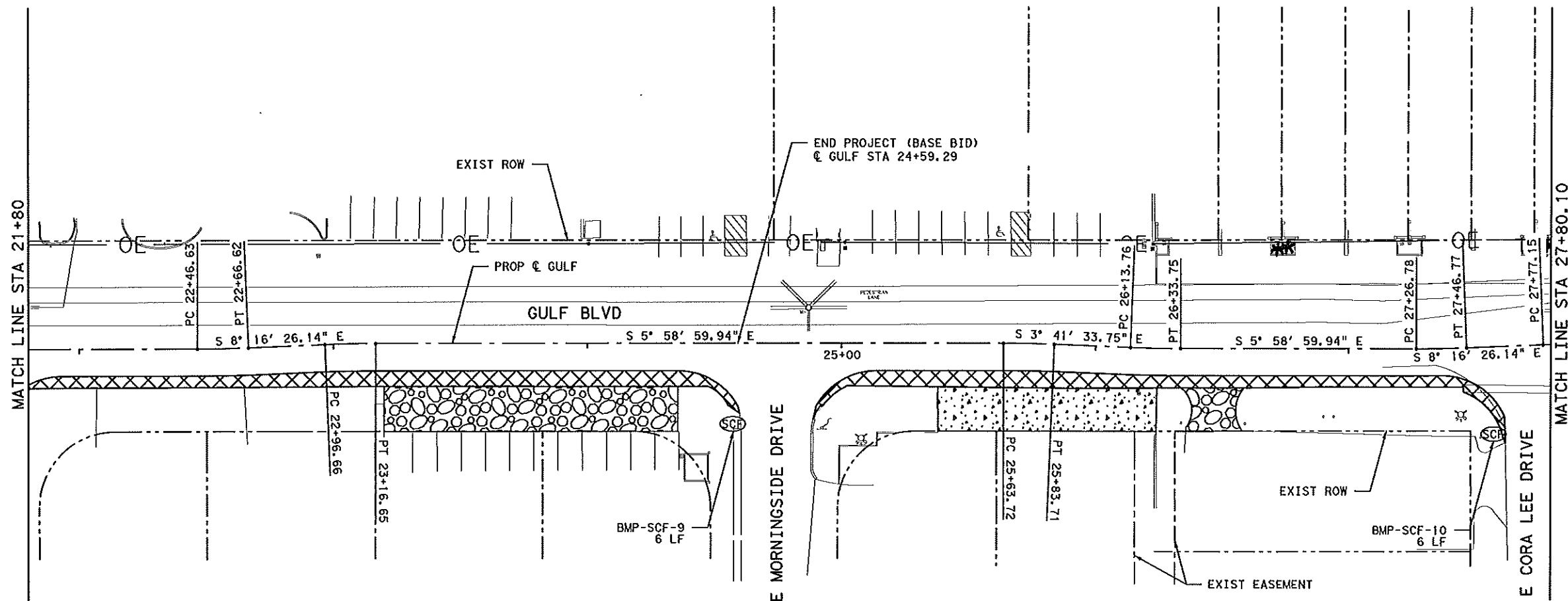

- LEGEND**
- PAVEMENT REMOVAL
 - VALLEY GUTTER REMOVAL
 - ASPHALT DRIVEWAY REMOVAL
 - CONCRETE DRIVEWAY REMOVAL
 - BRICK DRIVEWAY REMOVAL
 - MEDIAN ISLAND REMOVAL
 - SEDIMENT CONTROL FENCE

- NOTES:**
1. CONTRACTOR WILL BE REQUIRED TO PROTECT PALM TREES SHOWN TO REMAIN.
 2. APPLY SEEDING TO DISTURBED AREAS WITHIN ROW. SEEDING SHALL BE CONSIDERED SUBSIDIARY TO PERTINENT ITEMS.
 3. EROSION CONTROL DEVICES SHOWN SHALL BE CONSIDERED SUBSIDIARY TO PERTINENT ITEMS.
 4. INSTALL SEDIMENT CONTROL FENCE IN DITCHES LOCATED ALONG THE CROSS STREETS OF GULF BLVD.
 5. CONTRACTOR TO REMOVE EXISTING STRIPING ON EAST DRIVEWAYS BY SAND BLASTING OR OTHER METHOD OF REMOVAL TO BE APPROVED BY ENGINEER. THIS SHALL BE CONSIDERED SUBSIDIARY TO PERTINENT ITEMS.
 6. BURIED UTILITIES EXIST WITHIN CORRIDOR. CONTRACTOR TO LOCATE UTILITIES PRIOR TO CONSTRUCTION.

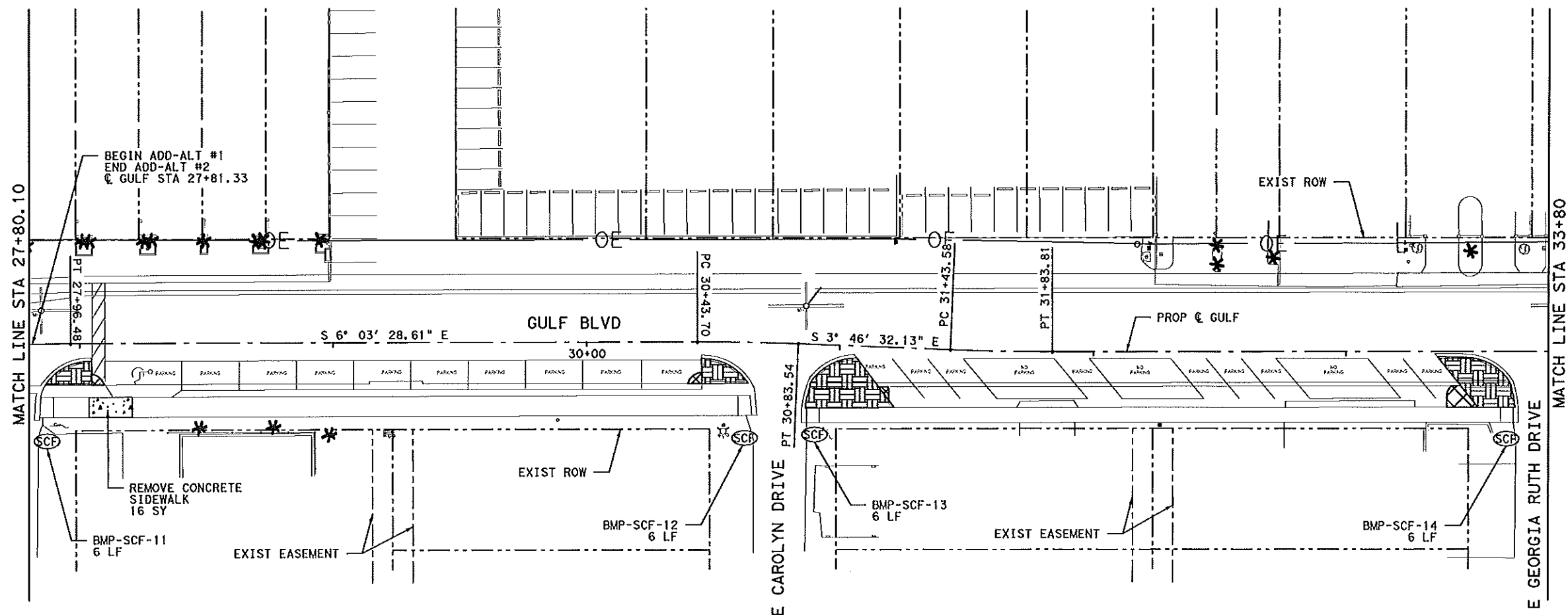
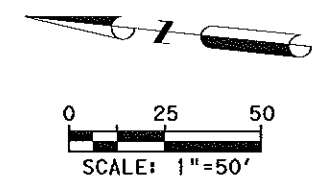

7/3/14

Kimley»Horn

South Padre ISLAND

EROSION CONTROL PLAN AND REMOVAL LAYOUT

GULF BLVD IMPROVEMENTS
 SHEET 2 OF 4

SCALE	PROJECT NO.	SHEET NO.
1" = 50'		5

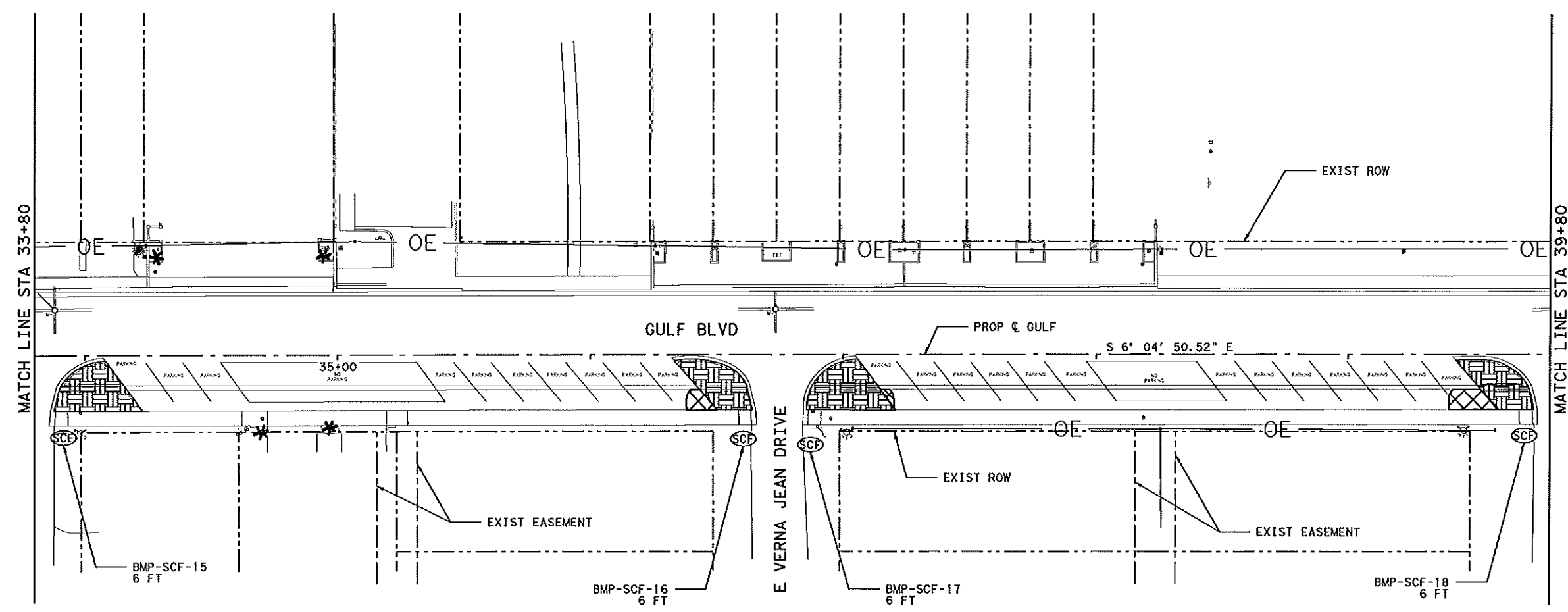

- LEGEND**
- PAVEMENT REMOVAL
 - VALLEY GUTTER REMOVAL
 - ASPHALT DRIVEWAY REMOVAL
 - CONCRETE DRIVEWAY REMOVAL
 - BRICK DRIVEWAY REMOVAL
 - MEDIAN ISLAND REMOVAL
 - SEDIMENT CONTROL FENCE

- NOTES:**
1. CONTRACTOR WILL BE REQUIRED TO PROTECT PALM TREES SHOWN TO REMAIN.
 2. APPLY SEEDING TO DISTURBED AREAS WITHIN ROW. SEEDING SHALL BE CONSIDERED SUBSIDIARY TO PERTINENT ITEMS.
 3. EROSION CONTROL DEVICES SHOWN SHALL BE CONSIDERED SUBSIDIARY TO PERTINENT ITEMS.
 4. INSTALL SEDIMENT CONTROL FENCE IN DITCHES LOCATED ALONG THE CROSS STREETS OF GULF BLVD.
 5. CONTRACTOR TO REMOVE EXISTING STRIPING ON EAST DRIVEWAYS BY SAND BLASTING OR OTHER METHOD OF REMOVAL TO BE APPROVED BY ENGINEER. THIS SHALL BE CONSIDERED SUBSIDIARY TO PERTINENT ITEMS.
 6. BURIED UTILITIES EXIST WITHIN CORRIDOR. CONTRACTOR TO LOCATE UTILITIES PRIOR TO CONSTRUCTION.

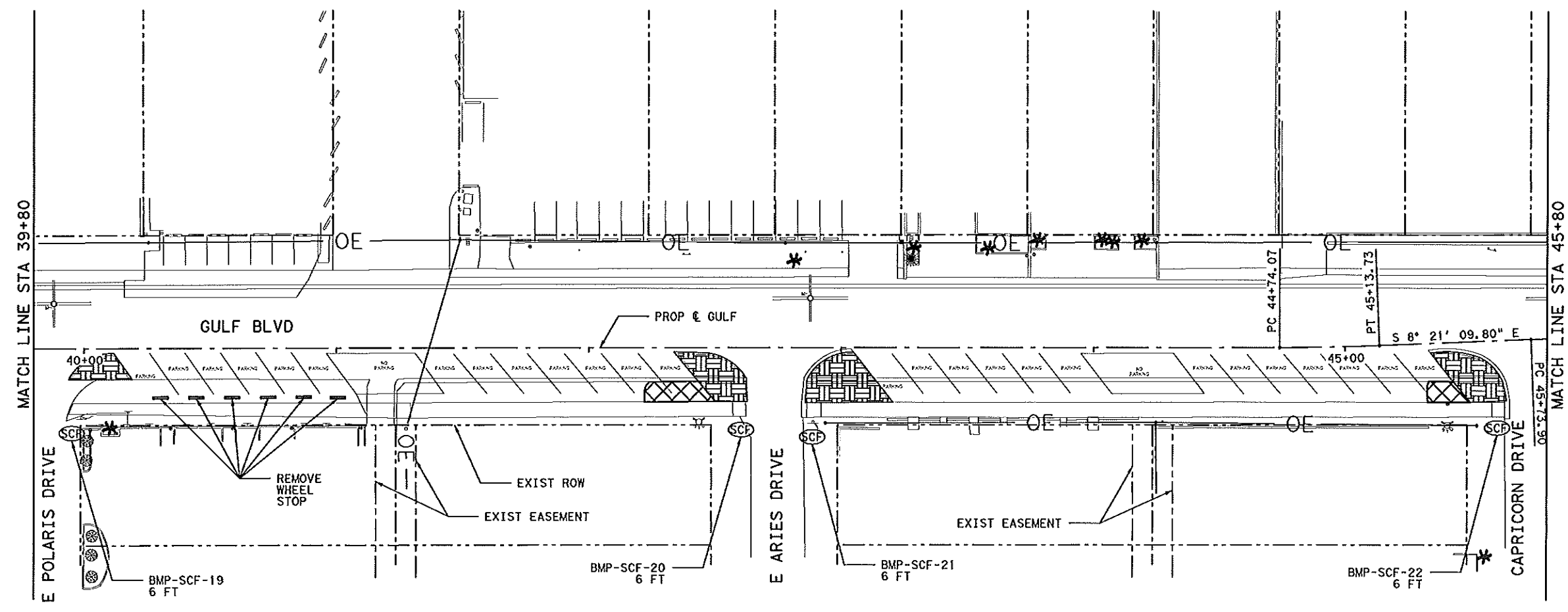
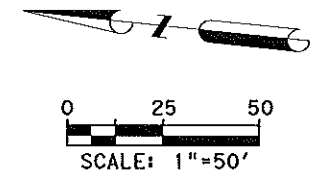

7/3/14

Brian C. Boecker

Kimley»Horn F-928

South Padre
ISLAND

EROSION CONTROL PLAN AND
REMOVAL LAYOUT

GULF BLVD IMPROVEMENTS
SHEET 3 OF 4

SCALE	PROJECT NO.	SHEET NO.
1" = 50'		6

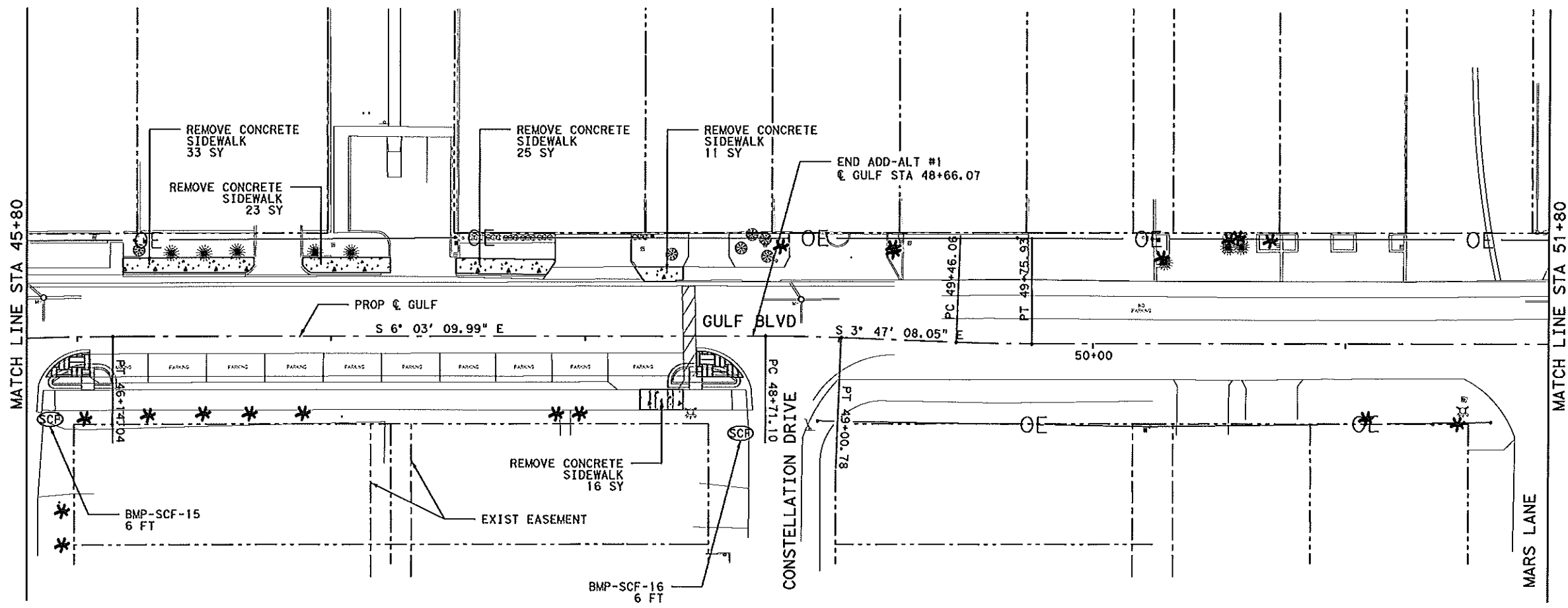

- LEGEND**
- PAVEMENT REMOVAL
 - VALLEY GUTTER REMOVAL
 - ASPHALT DRIVEWAY REMOVAL
 - CONCRETE DRIVEWAY REMOVAL
 - BRICK DRIVEWAY REMOVAL
 - MEDIAN ISLAND REMOVAL
 - SEDIMENT CONTROL FENCE

- NOTES:**
1. CONTRACTOR WILL BE REQUIRED TO PROTECT PALM TREES SHOWN TO REMAIN.
 2. APPLY SEEDING TO DISTURBED AREAS WITHIN ROW. SEEDING SHALL BE CONSIDERED SUBSIDIARY TO PERTINENT ITEMS.
 3. EROSION CONTROL DEVICES SHOWN SHALL BE CONSIDERED SUBSIDIARY TO PERTINENT ITEMS.
 4. INSTALL SEDIMENT CONTROL FENCE IN DITCHES LOCATED ALONG THE CROSS STREETS OF GULF BLVD.
 5. CONTRACTOR TO REMOVE EXISTING STRIPING ON EAST DRIVEWAYS BY SAND BLASTING OR OTHER METHOD OF REMOVAL TO BE APPROVED BY ENGINEER. THIS SHALL BE CONSIDERED SUBSIDIARY TO PERTINENT ITEMS.
 6. BURIED UTILITIES EXIST WITHIN CORRIDOR. CONTRACTOR TO LOCATE UTILITIES PRIOR TO CONSTRUCTION.

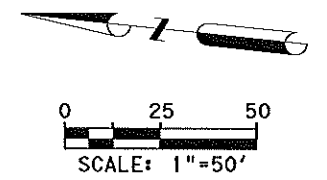

Kimley»Horn

F-928

EROSION CONTROL PLAN AND
REMOVAL LAYOUT

GULF BLVD IMPROVEMENTS
SHEET 4 OF 4

SCALE	PROJECT NO.	SHEET NO.
1" = 50'	-	7

LEGEND

- X-X PROPOSED SIGN
- X-X EXISTING SIGN TO REMAIN
- X-X EXISTING SIGN TO BE REMOVED
- X-X EXISTING SIGN TO BE RELOCATED
- X-X PROPOSED DRIVEWAY
- X-X PROPOSED PARKING BAY
- 1 REFL PAV MRK TY I (W) 4" (SLD)
- 2 REFL PAV MRK TY I (W) 12" (SLD)
- 3 REFL PAV MRK TY I (W) 24" (SLD)
- 4 REFL PAV MRK TY I (Y) 4" (BRK)
- 5 REFL PAV MRKR TY II-A-A
- 6 REFL PAV MRKR PROF PATTERN EDGELINE
- 7 REFL PAV MRK TY 1 (W) BIKE SYML
- 8 REFL PAV MRK TY 1 (W) PED SYML
- 9 REFL PAV MRK TY I (W) HANDICAP SYML
- 10 REFL PAV MRK TY I (W) WORD
- SUP SHARED USE PATH

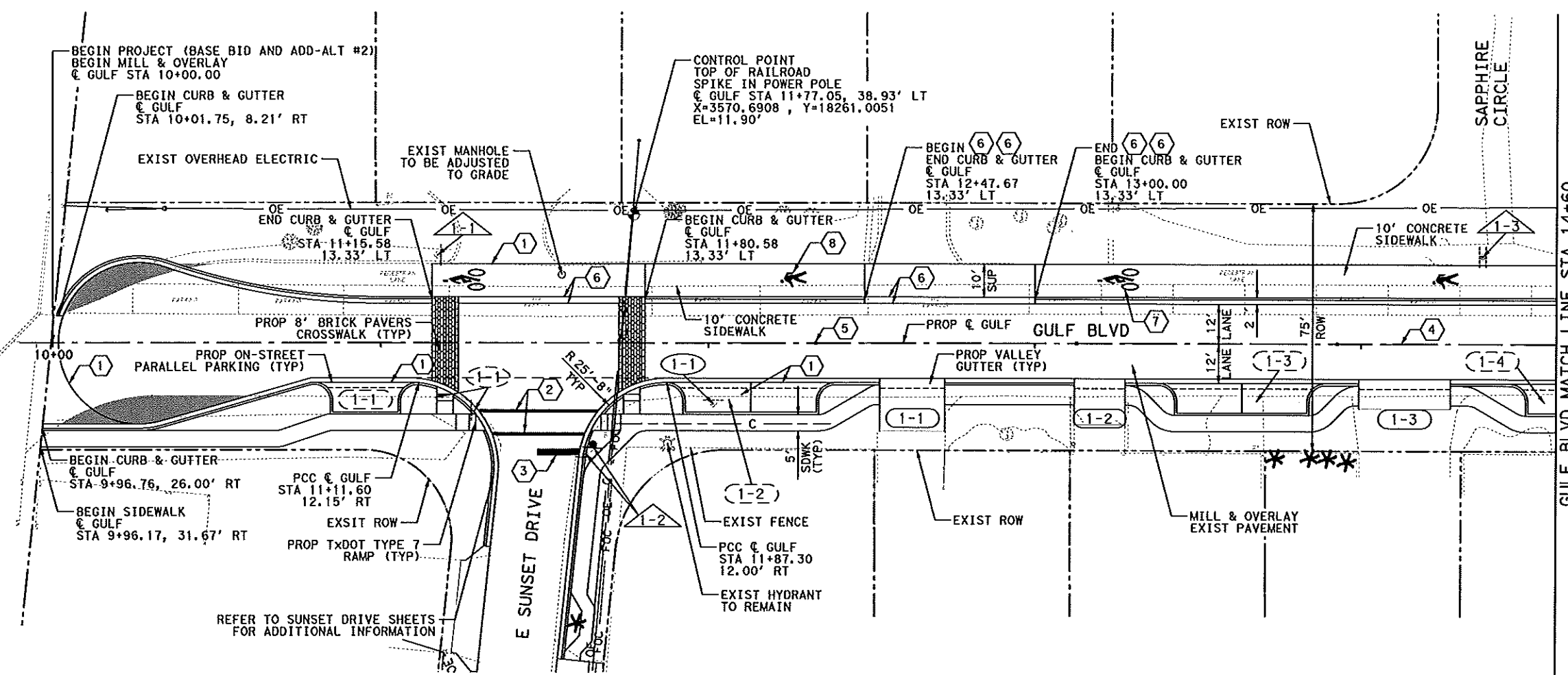
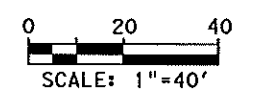
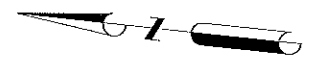

NOTES:

1. DIMENSIONS, STATIONS, AND OFFSETS GIVEN AT FACE OF CURB UNLESS OTHERWISE NOTED.
2. SEE MISCELLANEOUS DETAILS FOR DRIVEWAY AND PARKING BAY DETAILS.
3. SEE REMOVAL SHEETS FOR LIMITS OF DRIVEWAY REMOVAL.
4. SEE MISCELLANEOUS DETAILS FOR CURB TRANSITION DETAILS AT BEGIN/END CURBS.

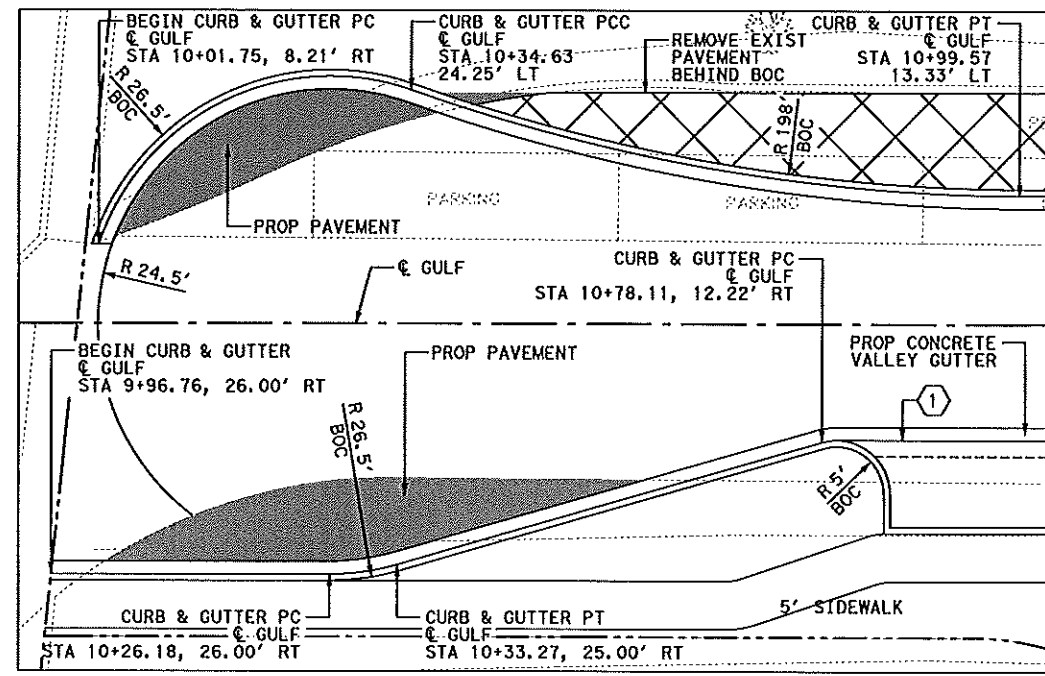
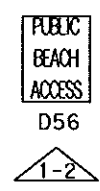
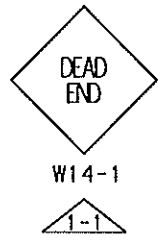

INSET CUL-DE-SAC DETAIL

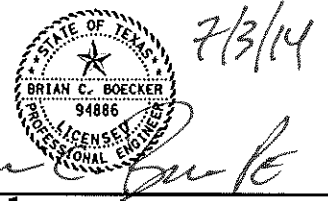

Kimley»Horn F-928











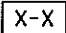



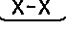
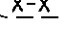
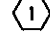
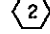

PLAN & PAVEMENT MARKINGS & SIGNAGE

GULF BLVD IMPROVEMENTS
SHEET 1 OF 9

SCALE	PROJECT NO.	SHEET NO.
1" = 40'		8

LEGEND

-  PROPOSED SIGN
-  EXISTING SIGN TO REMAIN
-  EXISTING SIGN TO BE REMOVED
-  EXISTING SIGN TO BE RELOCATED
-  PROPOSED DRIVEWAY
-  PROPOSED PARKING BAY
-  REFL PAV MRK TY I (W) 4" (SLD)
-  REFL PAV MRK TY I (W) 12" (SLD)
-  REFL PAV MRK TY I (W) 24" (SLD)
-  REFL PAV MRK TY I (Y) 4" (BRK)
-  REFL PAV MRKR TY II-A-A
-  REFL PAV MRKR PROF PATTERN EDGELINE
-  REFL PAV MRK TY I (W) BIKE SYML
-  REFL PAV MRK TY I (W) PED SYML
-  REFL PAV MRK TY I (W) HANDICAP SYML
-  REFL PAV MRK TY I (W) WORD
-  SHARED USE PATH

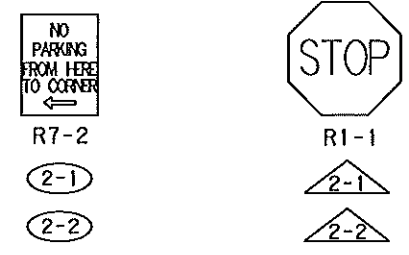
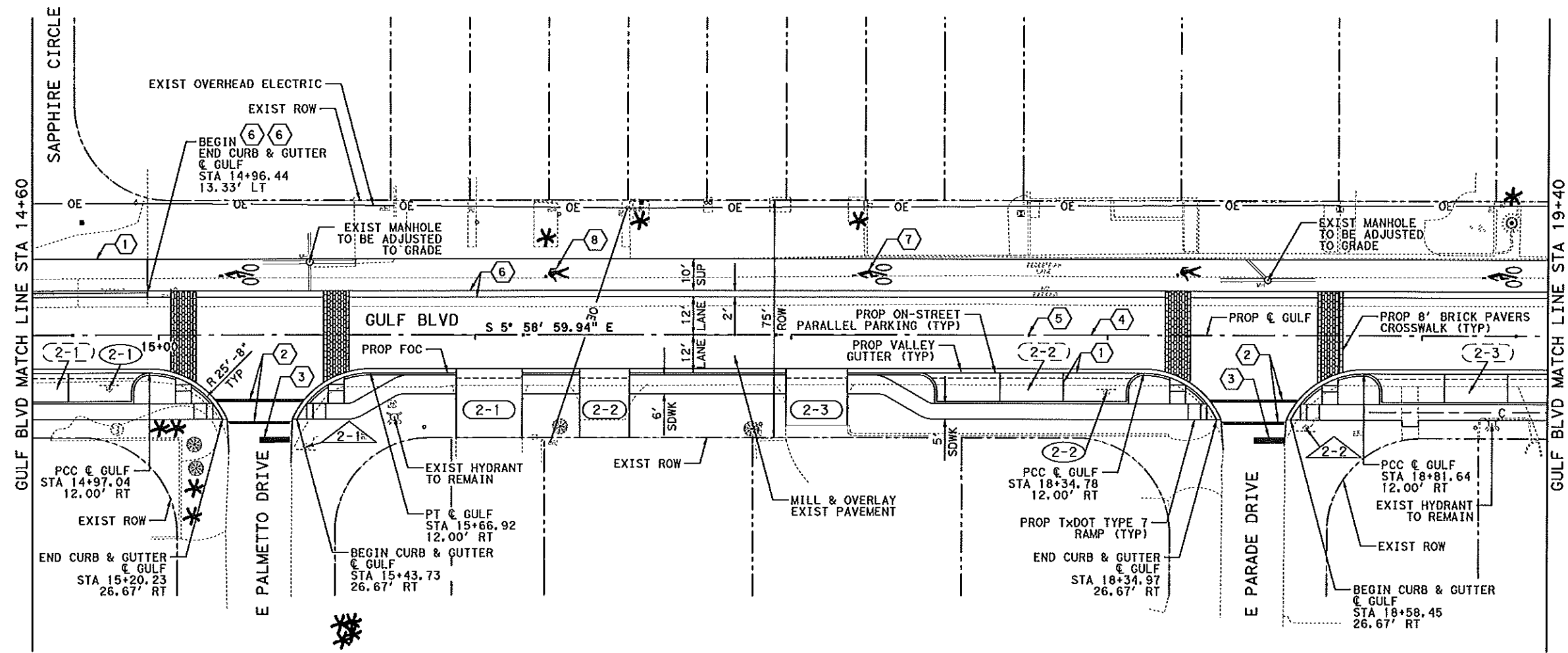
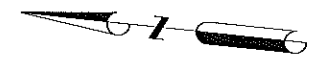

NOTES:

1. DIMENSIONS, STATIONS, AND OFFSETS GIVEN AT FACE OF CURB UNLESS OTHERWISE NOTED.
2. SEE MISCELLANEOUS DETAILS FOR DRIVEWAY AND PARKING BAY DETAILS.
3. SEE REMOVAL SHEETS FOR LIMITS OF DRIVEWAY REMOVAL.
4. SEE MISCELLANEOUS DETAILS FOR CURB TRANSITION DETAILS AT BEGIN/END CURBS.

7/3/14

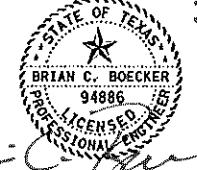

Brian C. Boecker

Kimley»Horn



PLAN & PAVEMENT MARKINGS & SIGNAGE

GULF BLVD IMPROVEMENTS
SHEET 2 OF 9

SCALE	PROJECT NO.	SHEET NO.
1" = 40'		9

LEGEND

- X-X PROPOSED SIGN
- X-X EXISTING SIGN TO REMAIN
- X-X EXISTING SIGN TO BE REMOVED
- X-X EXISTING SIGN TO BE RELOCATED
- X-X PROPOSED DRIVEWAY
- X-X PROPOSED PARKING BAY
- 1 REFL PAV MRK TY I (W) 4" (SLD)
- 2 REFL PAV MRK TY I (W) 12" (SLD)
- 3 REFL PAV MRK TY I (W) 24" (SLD)
- 4 REFL PAV MRK TY I (Y) 4" (BRK)
- 5 REFL PAV MRKR TY II-A-A
- 6 REFL PAV MRKR PROF PATTERN EDGELINE
- 7 REFL PAV MRK TY I (W) BIKE SYML
- 8 REFL PAV MRK TY I (W) PED SYML
- 9 REFL PAV MRK TY I (W) HANDICAP SYML
- 10 REFL PAV MRK TY I (W) WORD
- SUP SHARED USE PATH

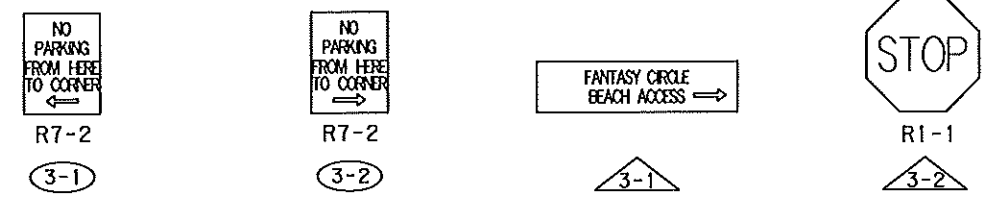
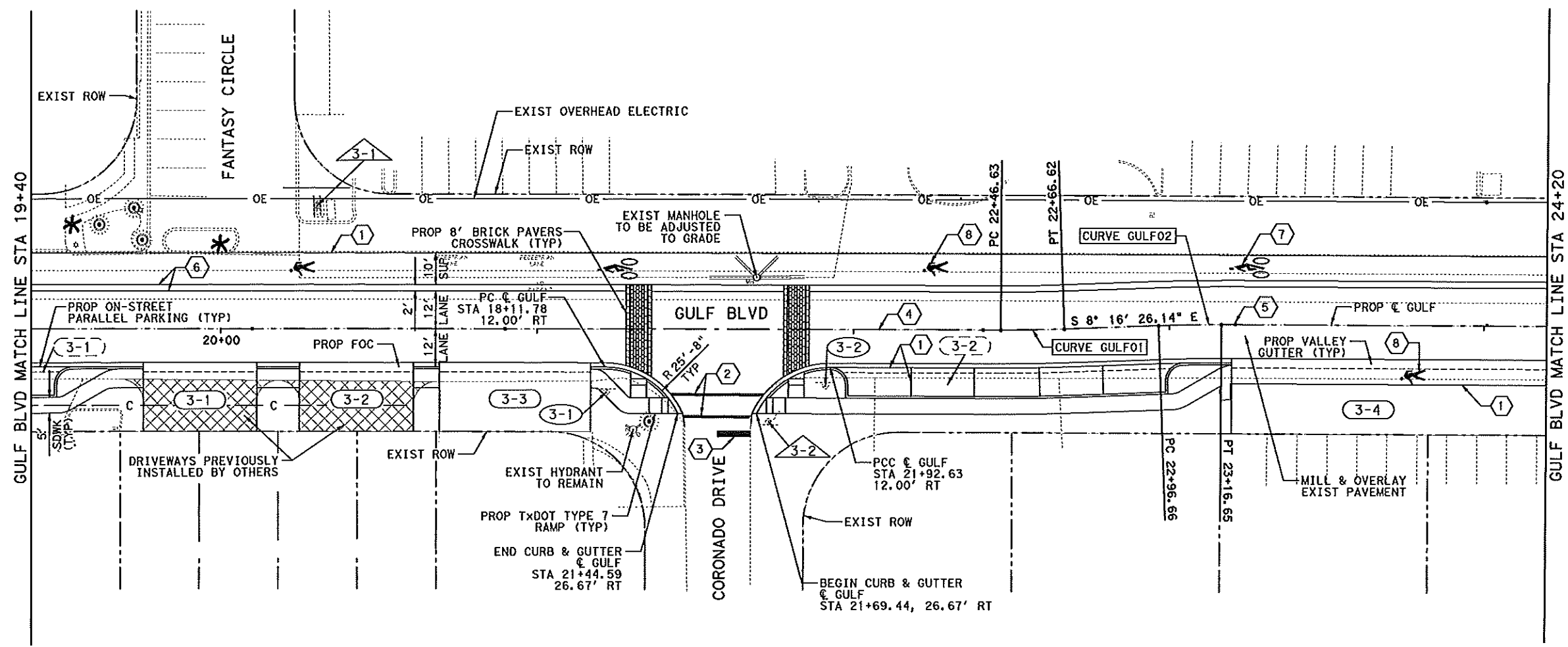
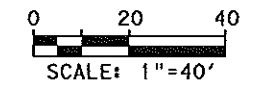

NOTES:

1. DIMENSIONS, STATIONS, AND OFFSETS GIVEN AT FACE OF CURB UNLESS OTHERWISE NOTED.
2. SEE MISCELLANEOUS DETAILS FOR DRIVEWAY AND PARKING BAY DETAILS.
3. SEE REMOVAL SHEETS FOR LIMITS OF DRIVEWAY REMOVAL.
4. SEE MISCELLANEOUS DETAILS FOR CURB TRANSITION DETAILS AT BEGIN/END CURBS.

Kimley»Horn

South Padre ISLAND

PLAN & PAVEMENT MARKINGS & SIGNAGE

GULF BLVD IMPROVEMENTS
 SHEET 3 OF 9

SCALE	PROJECT NO.	SHEET NO.
1" = 40'	-	10

LEGEND

- PROPOSED SIGN
- EXISTING SIGN TO REMAIN
- EXISTING SIGN TO BE REMOVED
- EXISTING SIGN TO BE RELOCATED
- PROPOSED DRIVEWAY
- PROPOSED PARKING BAY
- REFL PAV MRK TY I (W) 4" (SLD)
- REFL PAV MRK TY I (W) 12" (SLD)
- REFL PAV MRK TY I (W) 24" (SLD)
- REFL PAV MRK TY I (Y) 4" (BRK)
- REFL PAV MRKR TY II-A-A
- REFL PAV MRKR PROF PATTERN EDGELINE
- REFL PAV MRK TY I (W) BIKE SYML
- REFL PAV MRK TY I (W) PED SYML
- REFL PAV MRK TY I (W) HANDICAP SYML
- REFL PAV MRK TY I (W) WORD
- SHARED USE PATH

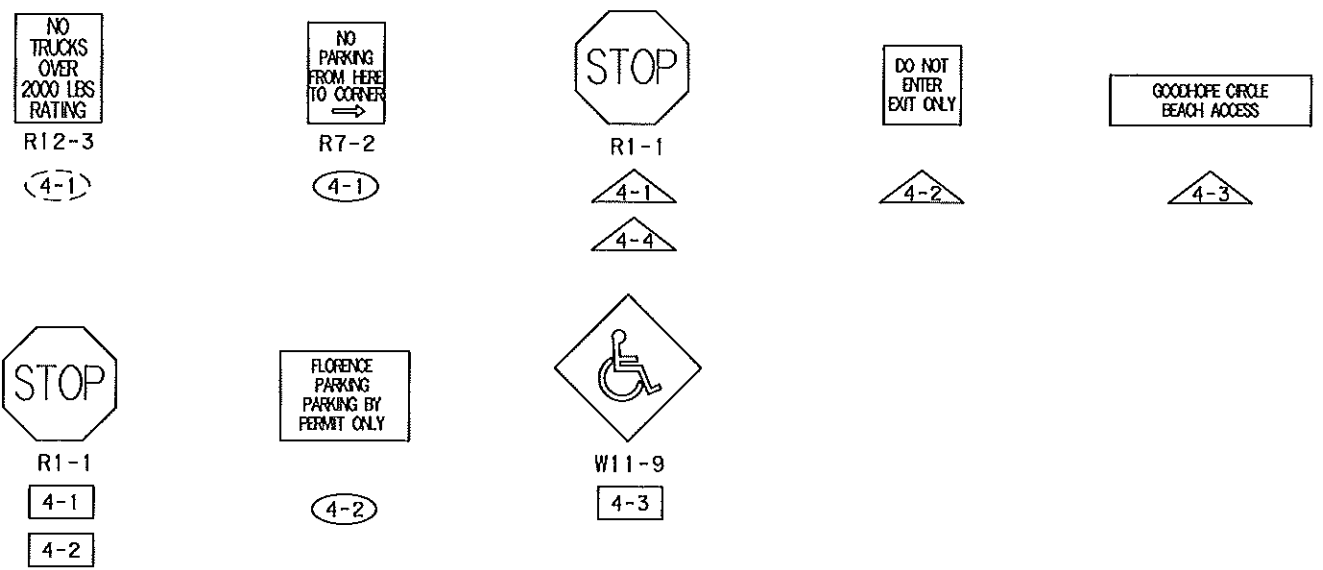
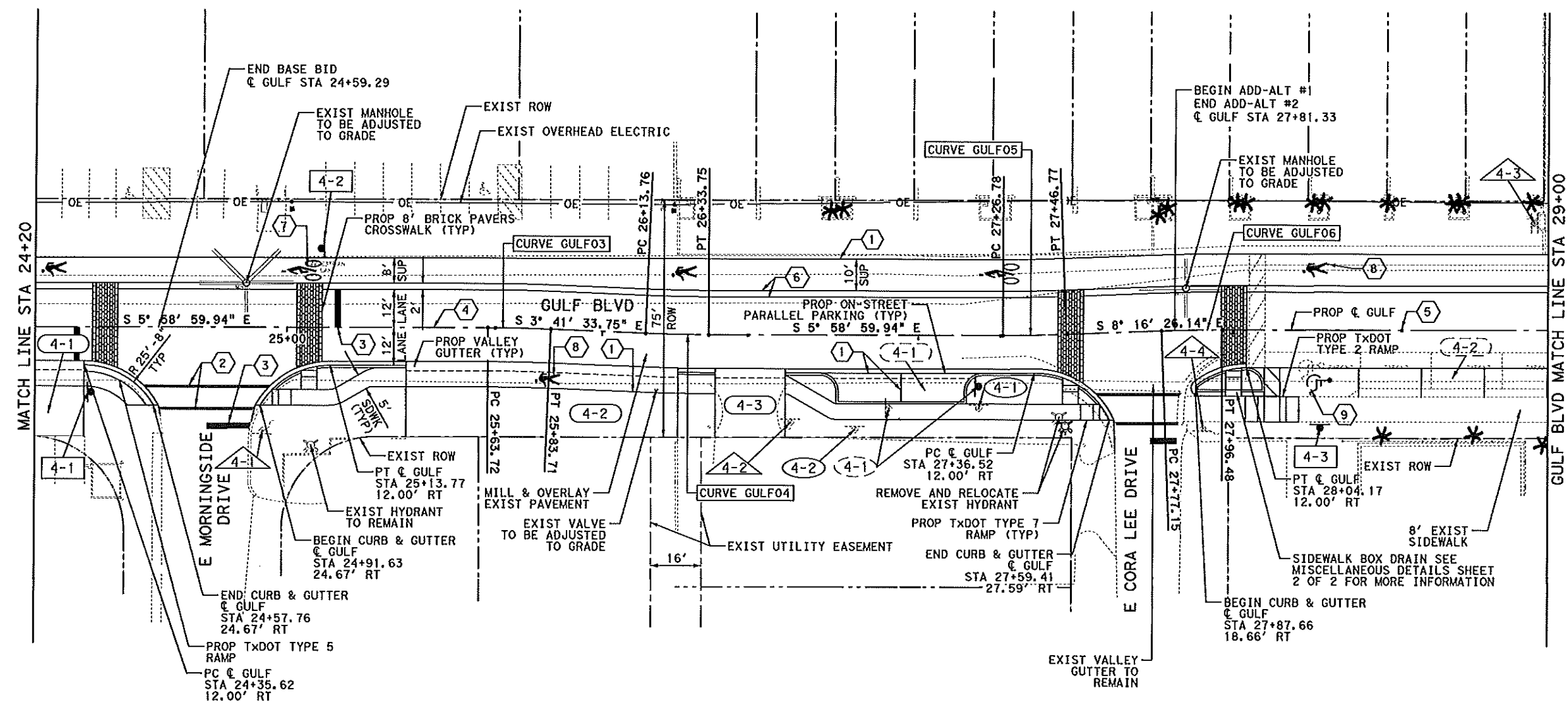
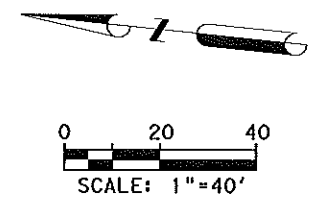

NOTES:

1. DIMENSIONS, STATIONS, AND OFFSETS GIVEN AT FACE OF CURB UNLESS OTHERWISE NOTED.
2. SEE MISCELLANEOUS DETAILS FOR DRIVEWAY AND PARKING BAY DETAILS.
3. SEE REMOVAL SHEETS FOR LIMITS OF DRIVEWAY REMOVAL.
4. SEE MISCELLANEOUS DETAILS FOR CURB TRANSITION DETAILS AT BEGIN/END CURBS.

Kimley»Horn

F-928

PLAN & PAVEMENT MARKINGS & SIGNAGE

GULF BLVD IMPROVEMENTS

SHEET 4 OF 9

SCALE	PROJECT NO.	SHEET NO.
1" = 40'		11

LEGEND

- PROPOSED SIGN
- EXISTING SIGN TO REMAIN
- EXISTING SIGN TO BE REMOVED
- EXISTING SIGN TO BE RELOCATED
- PROPOSED DRIVEWAY
- PROPOSED PARKING BAY
- REFL PAV MRK TY I (W) 4" (SLD)
- REFL PAV MRK TY I (W) 12" (SLD)
- REFL PAV MRK TY I (W) 24" (SLD)
- REFL PAV MRK TY I (Y) 4" (BRK)
- REFL PAV MRKR TY II-A-A
- REFL PAV MRKR PROF PATTERN EDGELINE
- REFL PAV MRK TY 1 (W) BIKE SYML
- REFL PAV MRK TY 1 (W) PED SYML
- REFL PAV MRK TY I (W) HANDICAP SYML
- REFL PAV MRK TY I (W) WORD
- SUP SHARED USE PATH

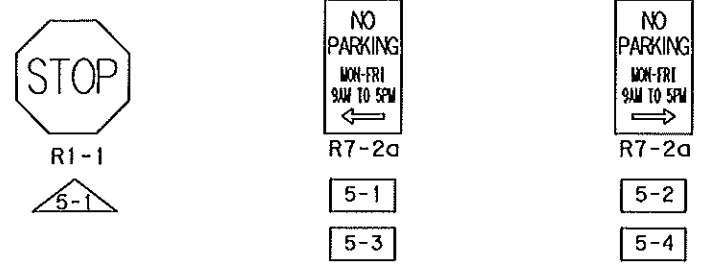
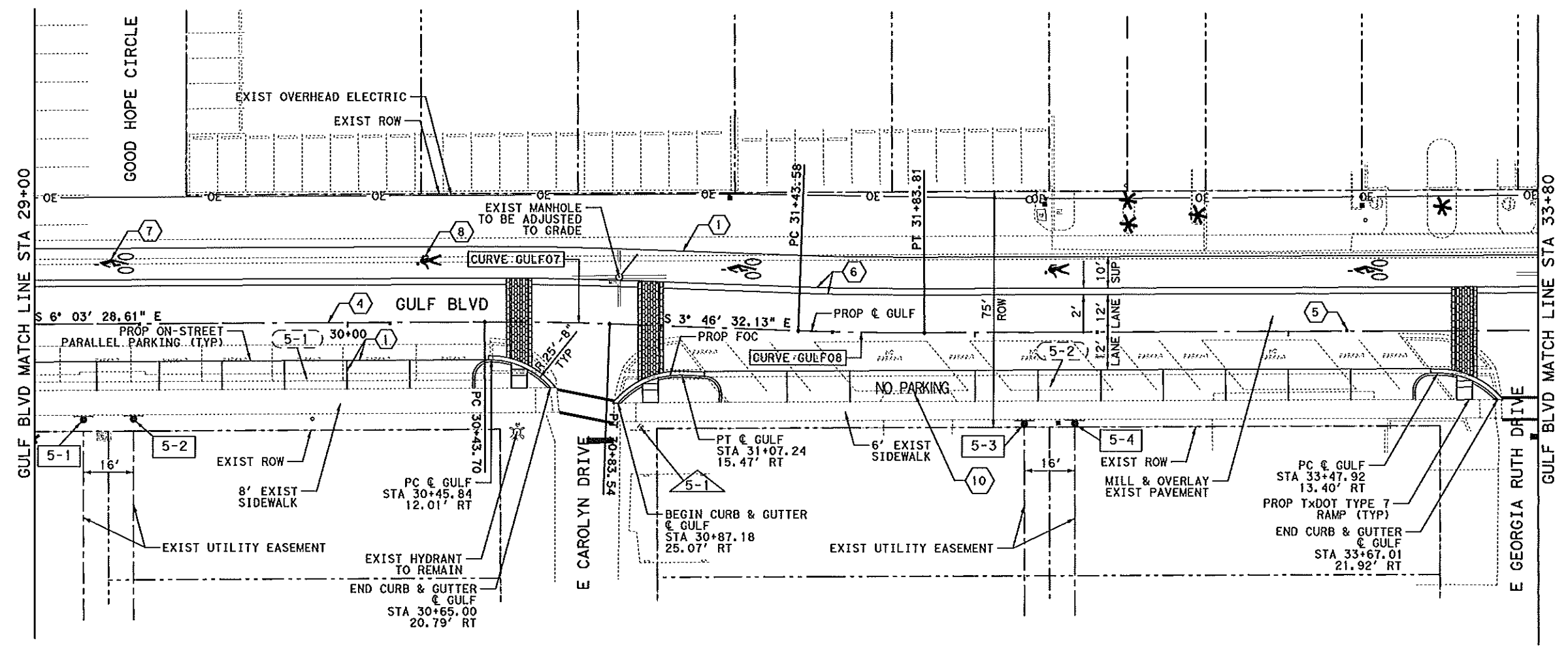
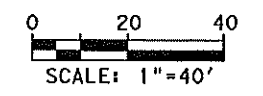

NOTES:

1. DIMENSIONS, STATIONS, AND OFFSETS GIVEN AT FACE OF CURB UNLESS OTHERWISE NOTED.
2. SEE MISCELLANEOUS DETAILS FOR DRIVEWAY AND PARKING BAY DETAILS.
3. SEE REMOVAL SHEETS FOR LIMITS OF DRIVEWAY REMOVAL.
4. SEE MISCELLANEOUS DETAILS FOR CURB TRANSITION DETAILS AT BEGIN/END CURBS.

Kimley»Horn

F-928

PLAN & PAVEMENT MARKINGS & SIGNAGE

GULF BLVD IMPROVEMENTS

SHEET 5 OF 9

SCALE	PROJECT NO.	SHEET NO.
1" = 40'		12

LEGEND

- (X-X) PROPOSED SIGN
- (X-X) EXISTING SIGN TO REMAIN
- (X-X) EXISTING SIGN TO BE REMOVED
- (X-X) EXISTING SIGN TO BE RELOCATED
- (X-X) PROPOSED DRIVEWAY
- (X-X) PROPOSED PARKING BAY
- (1) REFL PAV MRK TY I (W) 4" (SLD)
- (2) REFL PAV MRK TY I (W) 12" (SLD)
- (3) REFL PAV MRK TY I (W) 24" (SLD)
- (4) REFL PAV MRK TY I (Y) 4" (BRK)
- (5) REFL PAV MRKR TY II-A-A
- (6) REFL PAV MRKR PROF PATTERN EDGELINE
- (7) REFL PAV MRK TY 1 (W) BIKE SYML
- (8) REFL PAV MRK TY 1 (W) PED SYML
- (9) REFL PAV MRK TY I (W) HANDICAP SYML
- (10) REFL PAV MRK TY I (W) WORD
- SUP SHARED USE PATH

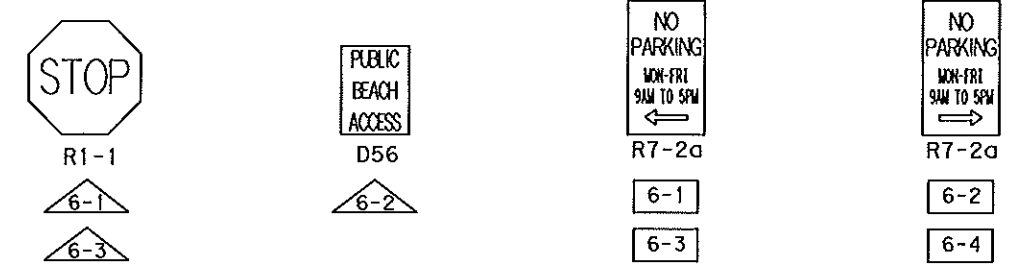
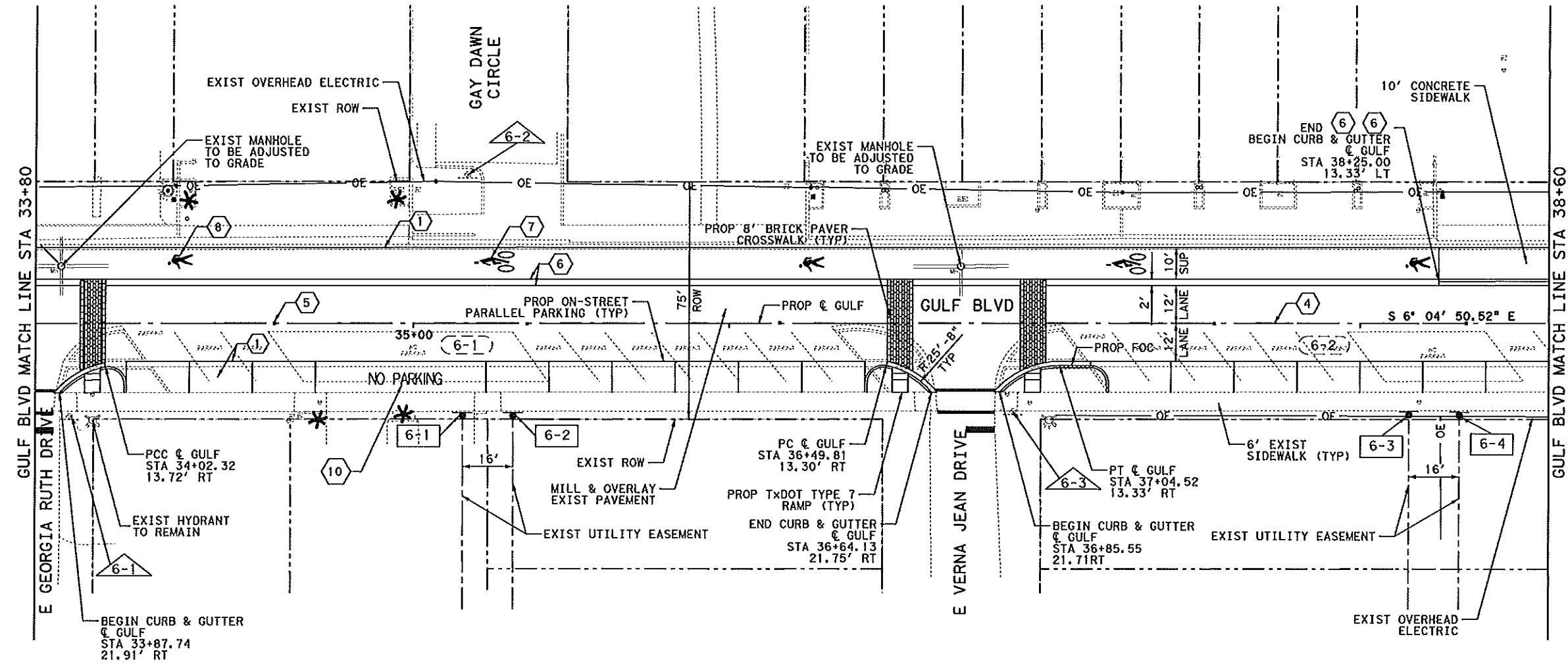
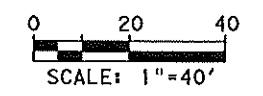

NOTES:

1. DIMENSIONS, STATIONS, AND OFFSETS GIVEN AT FACE OF CURB UNLESS OTHERWISE NOTED.
2. SEE MISCELLANEOUS DETAILS FOR DRIVEWAY AND PARKING BAY DETAILS.
3. SEE REMOVAL SHEETS FOR LIMITS OF DRIVEWAY REMOVAL.
4. SEE MISCELLANEOUS DETAILS FOR CURB TRANSITION DETAILS AT BEGIN/END CURBS.

F-928

PLAN & PAVEMENT MARKINGS & SIGNAGE

GULF BLVD IMPROVEMENTS
SHEET 6 OF 9

SCALE	PROJECT NO.	SHEET NO.
1" = 40'		13

LEGEND

- PROPOSED SIGN
- EXISTING SIGN TO REMAIN
- EXISTING SIGN TO BE REMOVED
- EXISTING SIGN TO BE RELOCATED
- PROPOSED DRIVEWAY
- PROPOSED PARKING BAY
- REFL PAV MRK TY I (W) 4" (SLD)
- REFL PAV MRK TY I (W) 12" (SLD)
- REFL PAV MRK TY I (W) 24" (SLD)
- REFL PAV MRK TY I (Y) 4" (BRK)
- REFL PAV MRKR TY II-A-A
- REFL PAV MRKR PROF PATTERN EDGELINE
- REFL PAV MRK TY 1 (W) BIKE SYML
- REFL PAV MRK TY 1 (W) PED SYML
- REFL PAV MRK TY 1 (W) HANDICAP SYML
- REFL PAV MRK TY I (W) WORD
- SHARED USE PATH

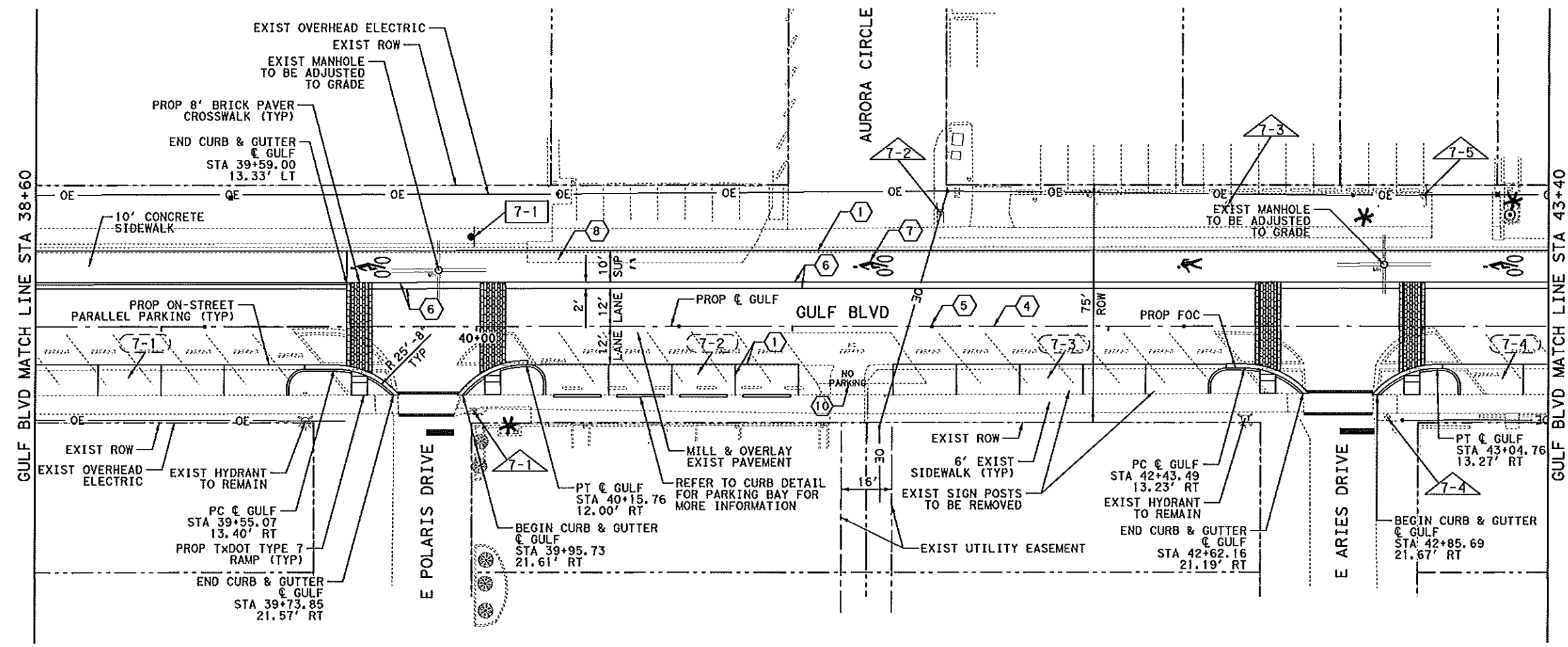
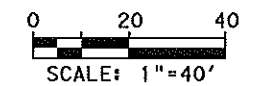

R1-1



INTERNACIONAL
CONDOMINIUMS
PROPERTY MANAGEMENT BY
ISLAND SERVICES



AURORA CIRCLE
BEACH ACCESS →



NO
THRU
TRAFFIC



R8-3A

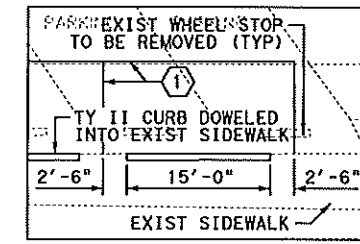

CURB DETAIL FOR PARKING BAY 7-2

NOTES:

1. DIMENSIONS, STATIONS, AND OFFSETS GIVEN AT FACE OF CURB UNLESS OTHERWISE NOTED.
2. SEE MISCELLANEOUS DETAILS FOR DRIVEWAY AND PARKING BAY DETAILS.
3. SEE REMOVAL SHEETS FOR LIMITS OF DRIVEWAY REMOVAL.
4. SEE MISCELLANEOUS DETAILS FOR CURB TRANSITION DETAILS AT BEGIN/END CURBS.

7/3/14

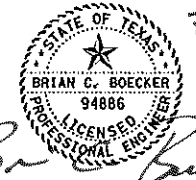

Kimley»Horn



PLAN & PAVEMENT MARKINGS & SIGNAGE

GULF BLVD IMPROVEMENTS
SHEET 7 OF 9

SCALE	PROJECT NO.	SHEET NO.
1" = 40'		14

LEGEND

- [X-X] PROPOSED SIGN
- [X-X] EXISTING SIGN TO REMAIN
- (X-X) EXISTING SIGN TO BE REMOVED
- (X-X) EXISTING SIGN TO BE RELOCATED
- [X-X] PROPOSED DRIVEWAY
- (X-X) PROPOSED PARKING BAY
- ① REFL PAV MRK TY I (W) 4" (SLD)
- ② REFL PAV MRK TY I (W) 12" (SLD)
- ③ REFL PAV MRK TY I (W) 24" (SLD)
- ④ REFL PAV MRK TY I (Y) 4" (BRK)
- ⑤ REFL PAV MRKR TY II-A-A
- ⑥ REFL PAV MRKR PROF PATTERN EDGELINE
- ⑦ REFL PAV MRK TY 1 (W) BIKE SYML
- ⑧ REFL PAV MRK TY 1 (W) PED SYML
- ⑨ REFL PAV MRK TY I (W) HANDICAP SYML
- ⑩ REFL PAV MRK TY I (W) WORD
- SUP SHARED USE PATH

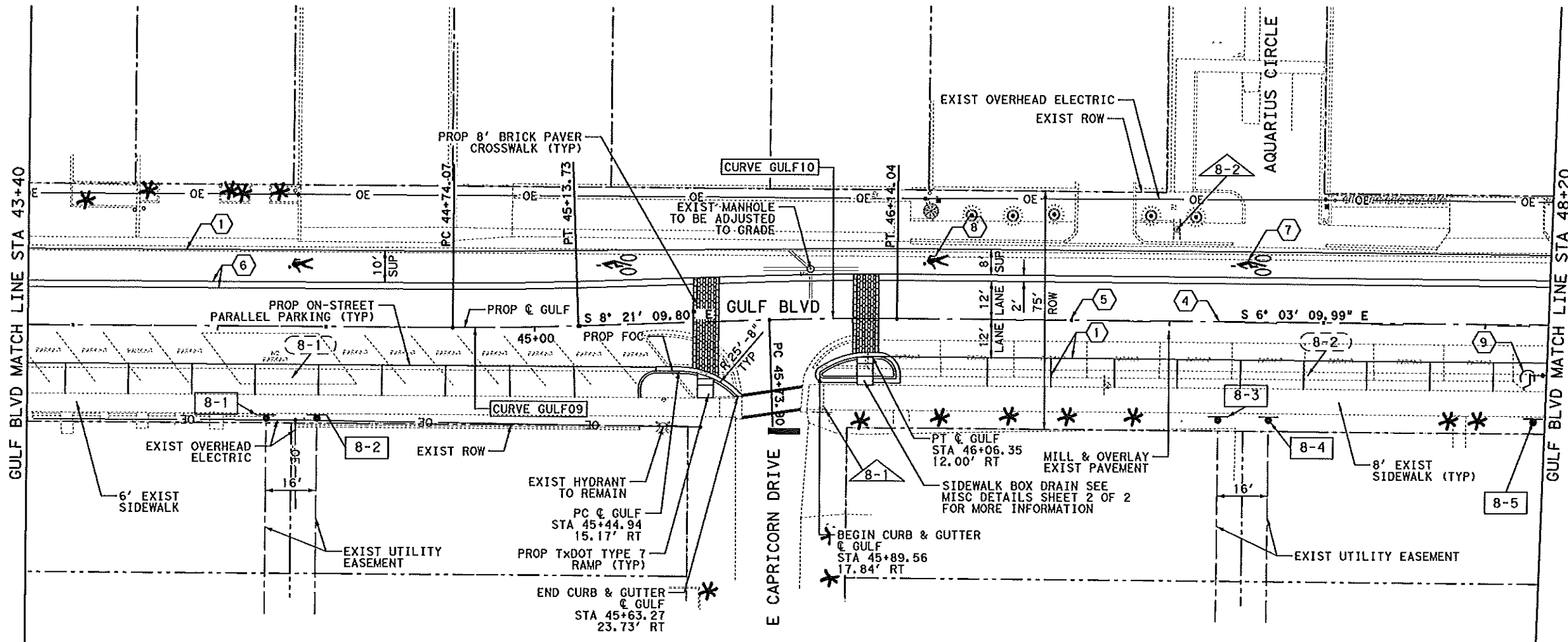
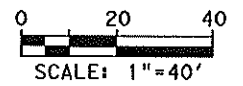

R1-1

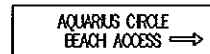

R7-2a



R7-2a



W11-9



NOTES:

1. DIMENSIONS, STATIONS, AND OFFSETS GIVEN AT FACE OF CURB UNLESS OTHERWISE NOTED.
2. SEE MISCELLANEOUS DETAILS FOR DRIVEWAY AND PARKING BAY DETAILS.
3. SEE REMOVAL SHEETS FOR LIMITS OF DRIVEWAY REMOVAL.
4. SEE MISCELLANEOUS DETAILS FOR CURB TRANSITION DETAILS AT BEGIN/END CURBS.

7/3/14
 BRIAN C. BOECKER
 94886
 LICENSED PROFESSIONAL ENGINEER

Kimley»Horn

South Padre ISLAND

PLAN & PAVEMENT MARKINGS & SIGNAGE

GULF BLVD IMPROVEMENTS
 SHEET 8 OF 9

SCALE	PROJECT NO.	SHEET NO.
1" = 40'		15