

Landry Architecture LLC
1618 St. Charles Ave
New Orleans, LA 70115
peggy@landryarch.com

Addendum No. 3

10.05.23

Addendum No. 3: Response to Request for Information in connection with The Invitation to Bid Construction Services: ITB No. 08-79-05624, Historical Museum of South Padre Renovation Project.

1. The contractor shall use Sopraseal, LM 202 VP damp-proofing on the CMU.
2. The contractor shall use 1x (or 2x) wood furring strips as required to achieve a plane Hardie-board finish.
3. The depth of piers is shown in Addendum No. 1, which is attached hereto (10' above existing grade).
4. The sidewalk, driveway and parking pavers are Pavestone, Holland Stone Parkway Series-Color selection by Owner during construction.
5. The Hardie-Board selection is described in Addendum No. 1, which is attached hereto.
6. As described on the Cover Sheet notes, the building is required to be fully sprinklered.
7. The Bid must provide an allowance for landscaping, landscape lighting and landscape irrigation.
8. The window and doors are noted on the floor plan per Addendum No. 1. The entry doors and rear doors are Tiltco aluminum white and require shop drawings from Tiltco. The size of the doors in a drawing, which is attached hereto.
9. The exterior nails are hot-dipped galvanized.
10. The window in the dormer is a Showcase 4'x6' window.
11. Dimensions for hexagon is shown on the ceiling plan, revised sheet 9.1, which is attached hereto.
12. Provide decking on all of the steel joists per structural.
13. The Bid should include the equipment shown in The Maintenance/Storage Rm. All of the equipment must be commercial grade: (2) 30"x60" stainless steel tables, 48" commercial refrigerator, large commercial microwave, 36" commercial sink in a stainless built in counter as shown on the floor plan.

Please contact Peggy Landry @ peggylandry@landryarch.com for any questions or clarifications.

Kind regards,

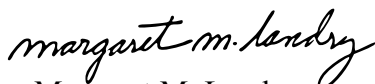

Margaret M. Landry
504.319.7344

ADDENDUM NO. 3

October 05, 2023

PROJECT: Invitation to Bid Construction Services: ITB No. 08-79-05624 Historical Museum of South Padre Renovation Project

OWNER: CITY OF SOUTH PADRE ISLAND
4601 PADRE BLVD.
SOUTH PADRE ISLAND, TX 78597

BID OPENING: Tuesday, October 10, 2023 @ 2:00 p.m.

TO ALL BIDDERS BIDDING ON THE ABOVE PROJECT:

Prospective bidders are hereby notified of the above modifications to the Invitation to Bid documents. These modifications shall become part of the contract documents. The provisions of the contract documents not specifically affected by the addendum shall remain unchanged.

This Addendum forms a part of the Bidding Documents and will be incorporated into Contract Documents, as applicable. Insofar as the original Project is consistent, this Addendum governs, Acknowledge receipt of this Addendum by signing.

Randy Smith

Date

Acknowledge receipt by signing and returning to the City Manager's Office at NSoto@myspi.org.

SUBMITTING FIRM ACKNOWLEDGEMENT

Date

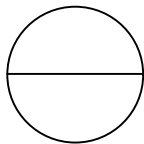
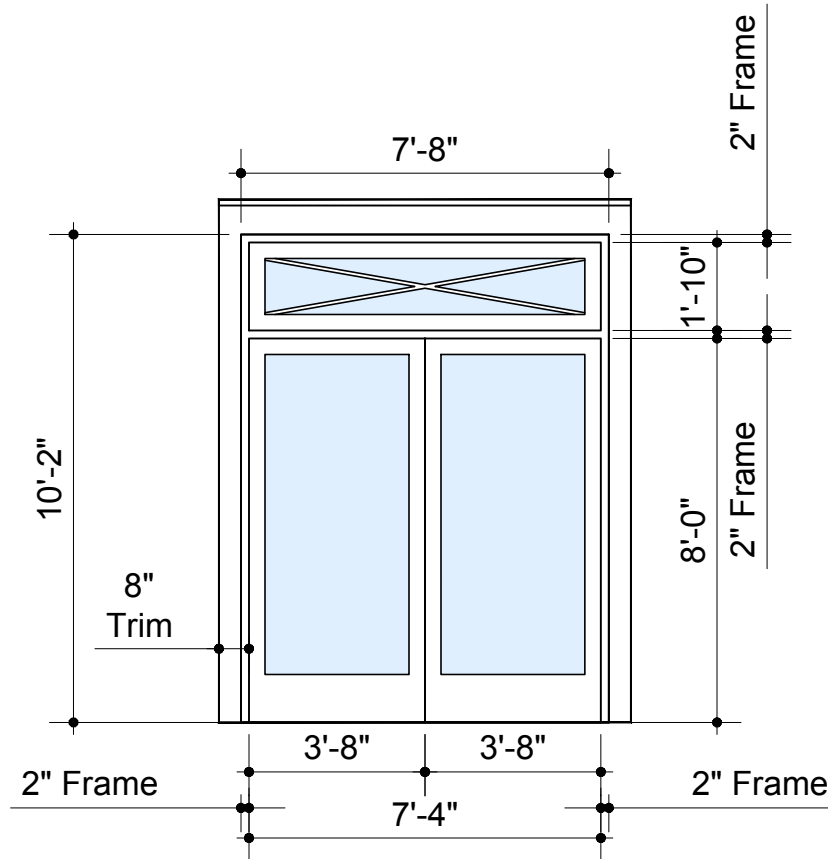

Tiltco French Door Elevation

Scale: 1/4" = 1'-0"

Addendum 03
October 5, 2023

Historical Museum of South Padre Island

— R E N O V A T I O N —
South Padre Island, Texas

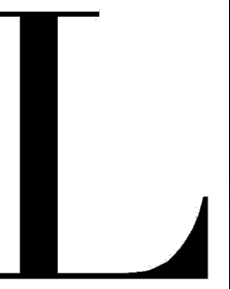

Reflected Ceiling Plans

Historical Museum
of South Padre Island
— RENOVATION —
South Padre Island, Texas

PROJECT NUMBER:	2126
DRAWN BY:	L.A.
CHECKED BY:	M.M.L.
DATE:	August 24, 2023
REVISIONS:	
ADD 3	October 5, 2023

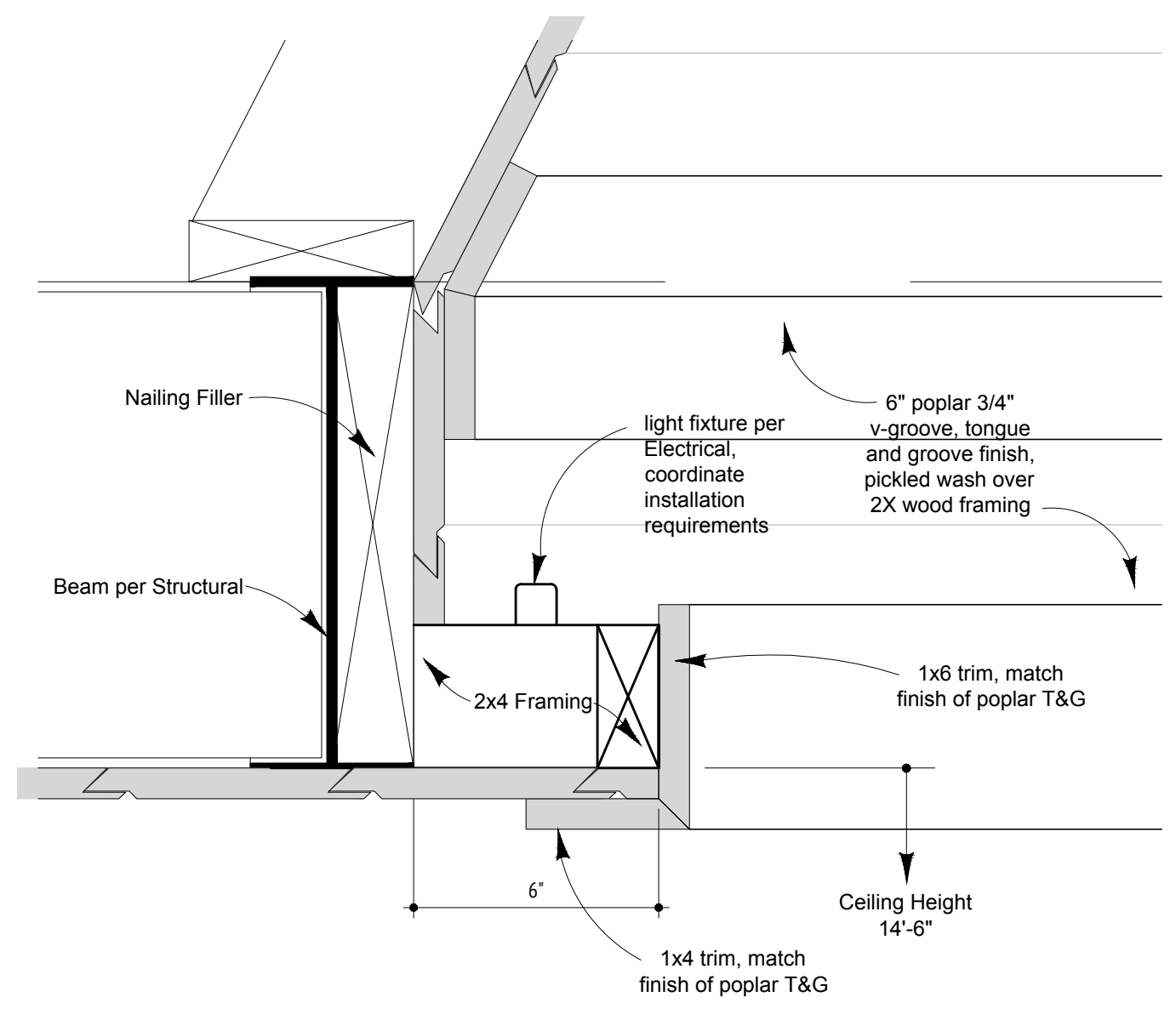
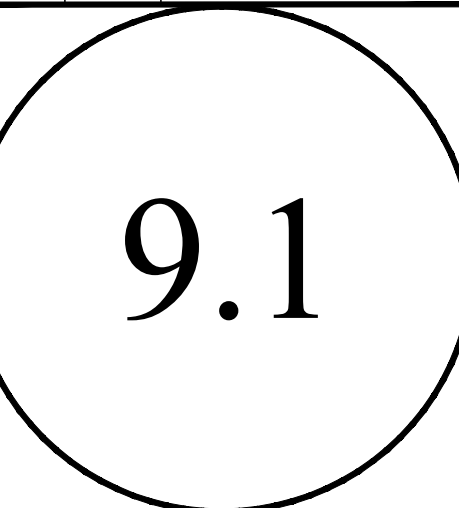

6 Typ. Detail at Cove
9.1 Scale: 3" = 1'-0"

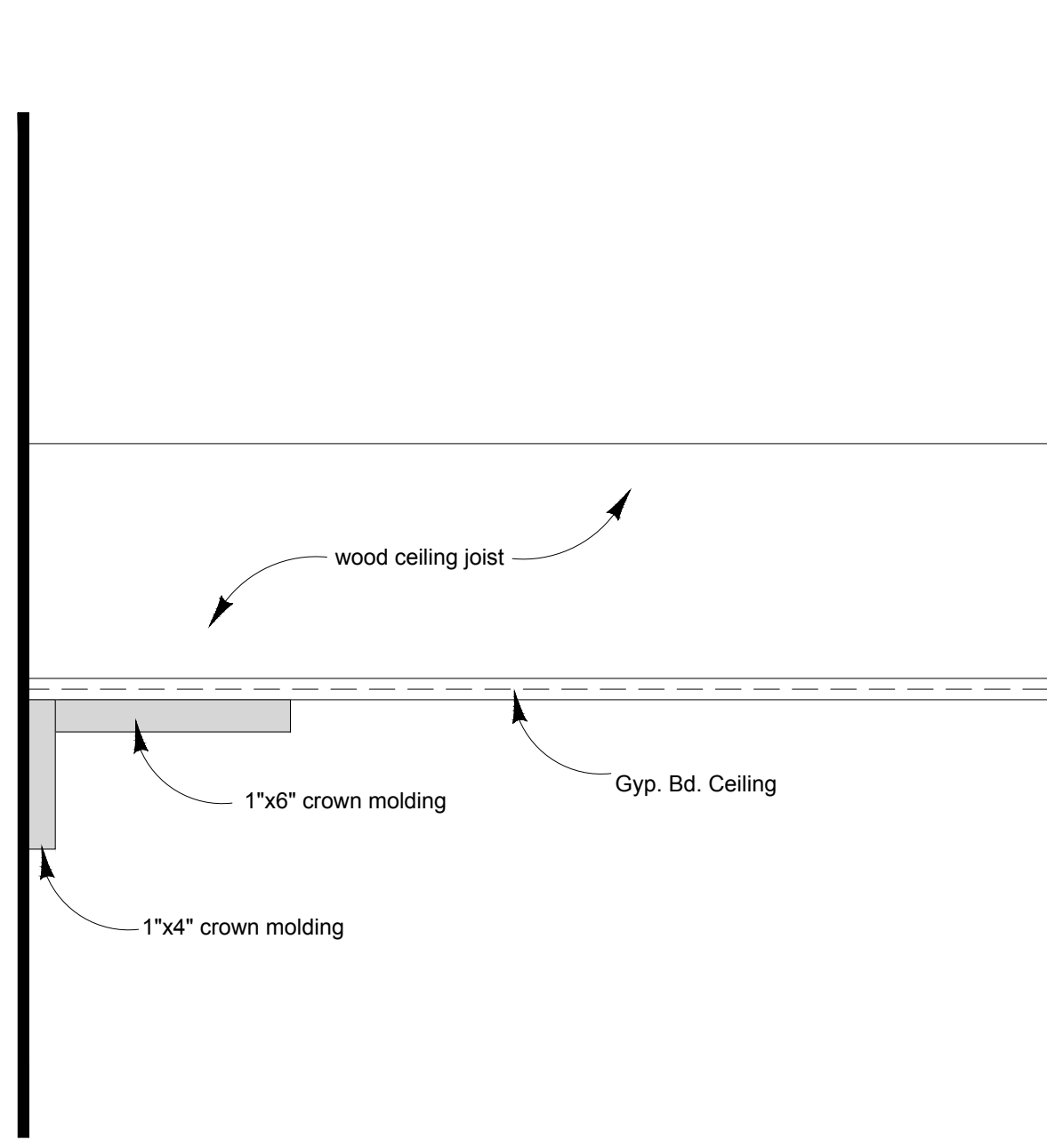

5 Typ. Detail at Gyp. Bd. Ceilings
9.1 Scale: 3" = 1'-0"

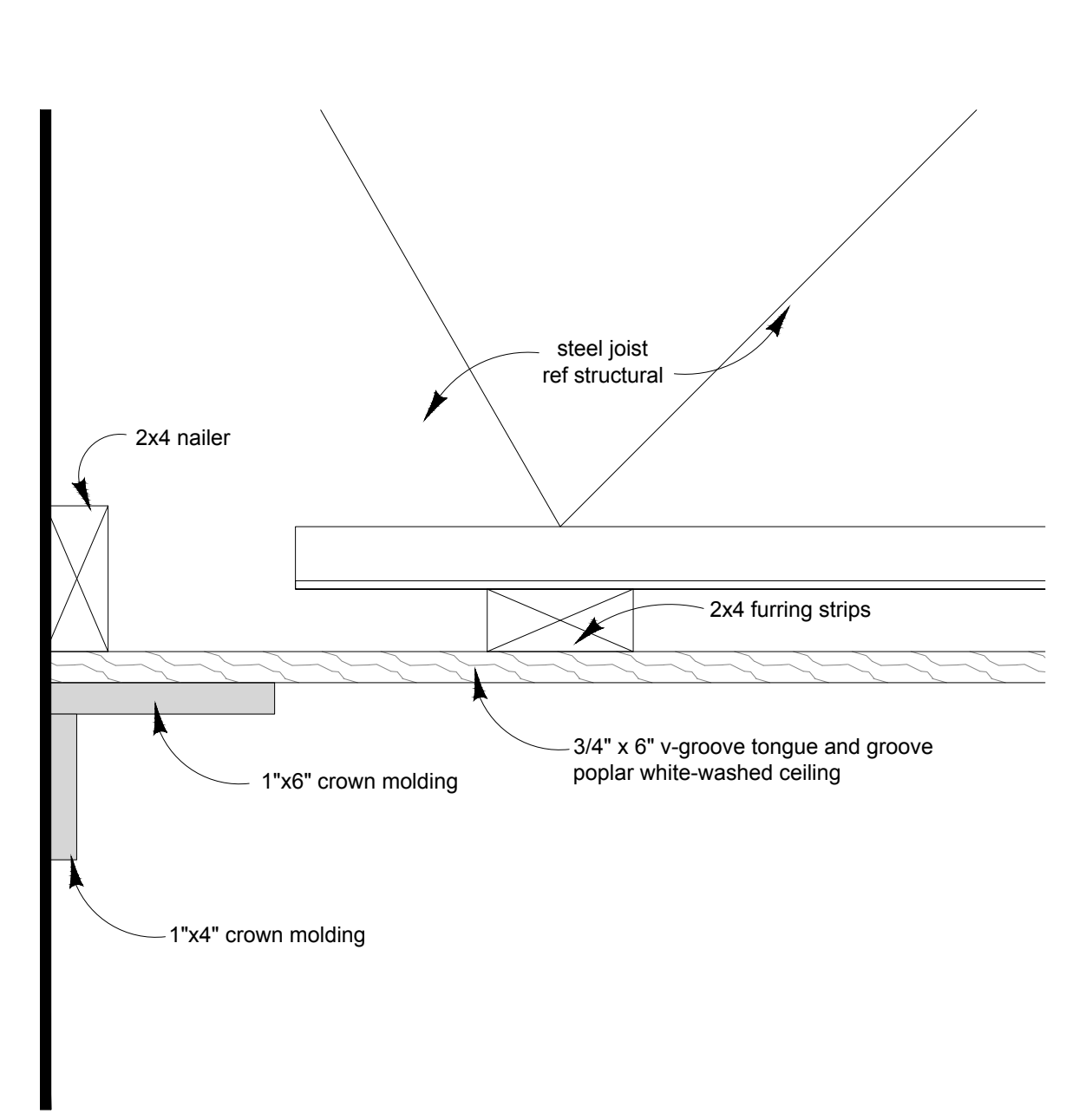

4 Typ. Ceiling Detail at Galleries
9.1 Scale: 3" = 1'-0"

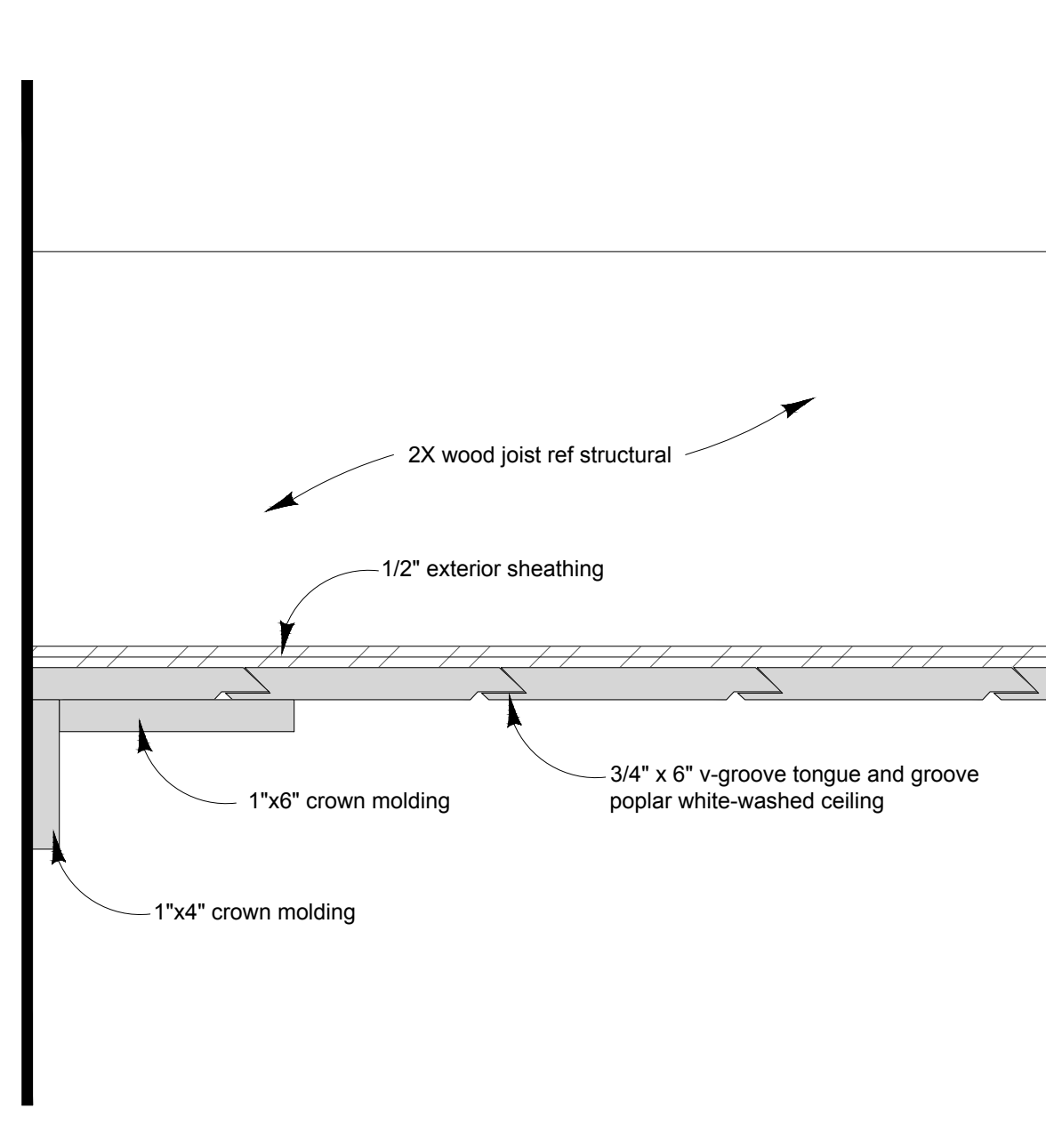

3 Typ. Soffit Detail at the Porches
9.1 Scale: 3" = 1'-0"

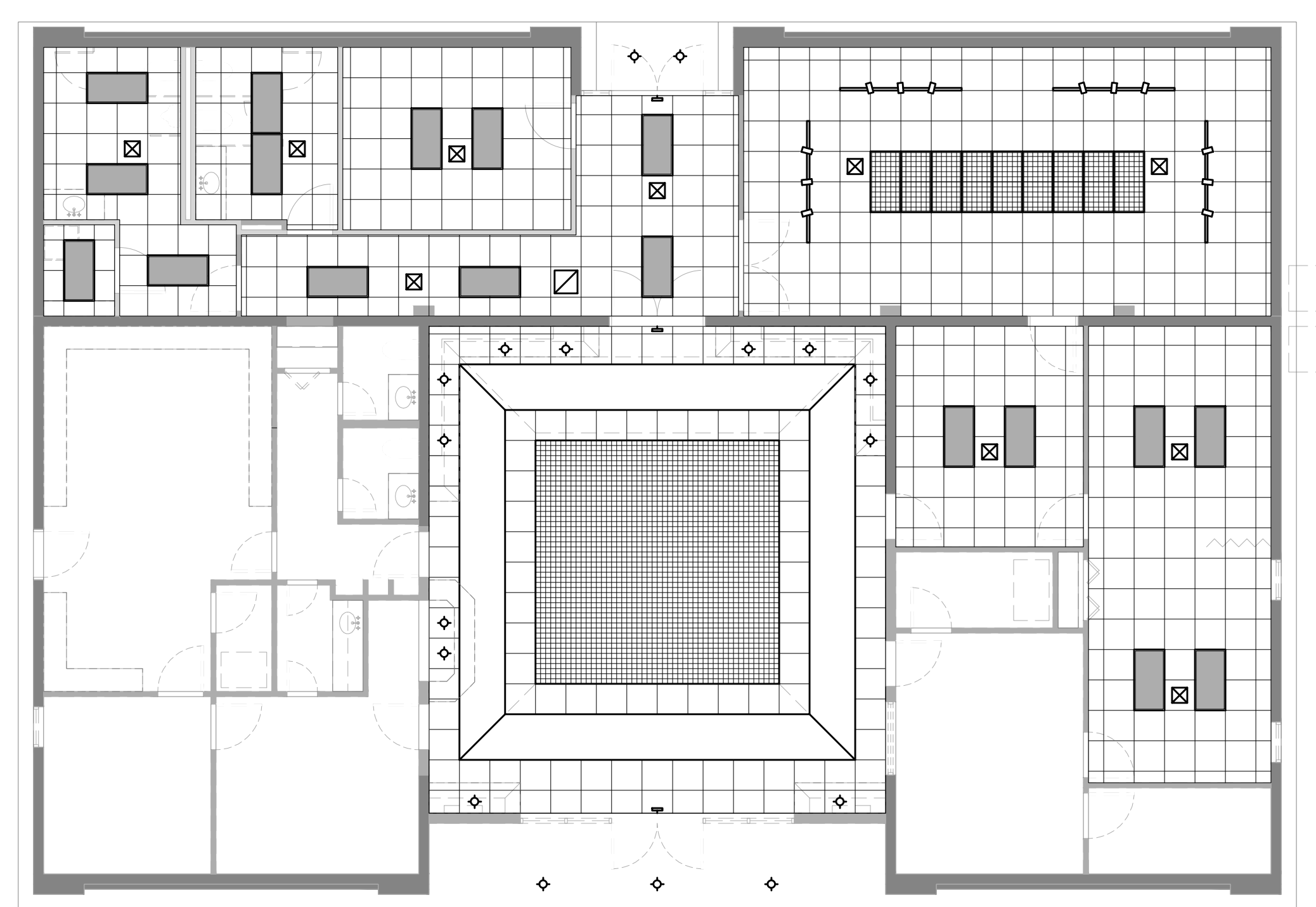

1 Existing Reflected Ceiling Plan
9.1 Scale: 1/8" = 1'-0"

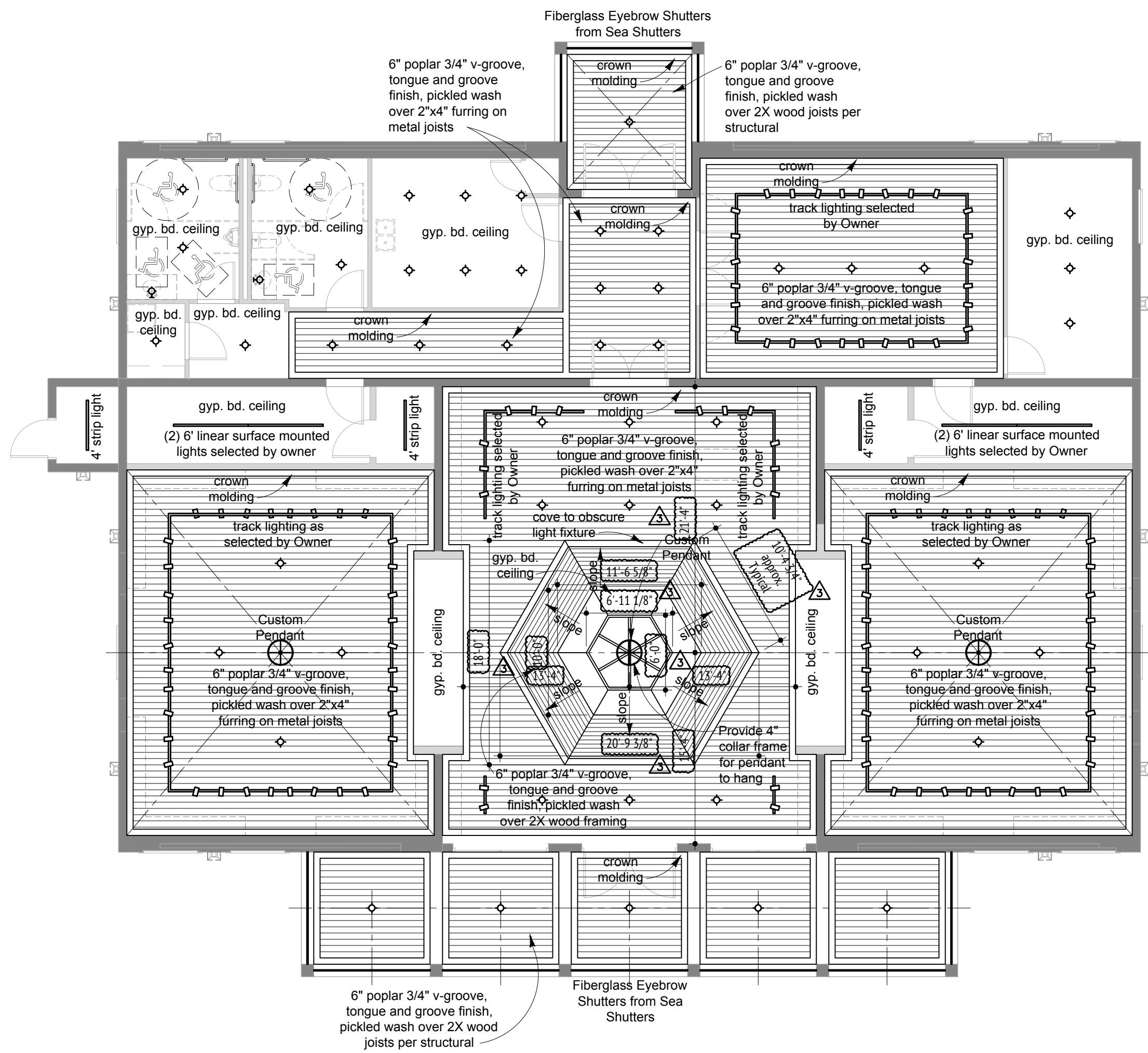

2 Proposed Reflected Ceiling Plan
9.1 Scale: 1/8" = 1'-0"