

PUNCHLIST PLANS FOR LAGUNA BOULEVARD STREET AND DRAINAGE IMPROVEMENTS

PROJECT
LOCATION

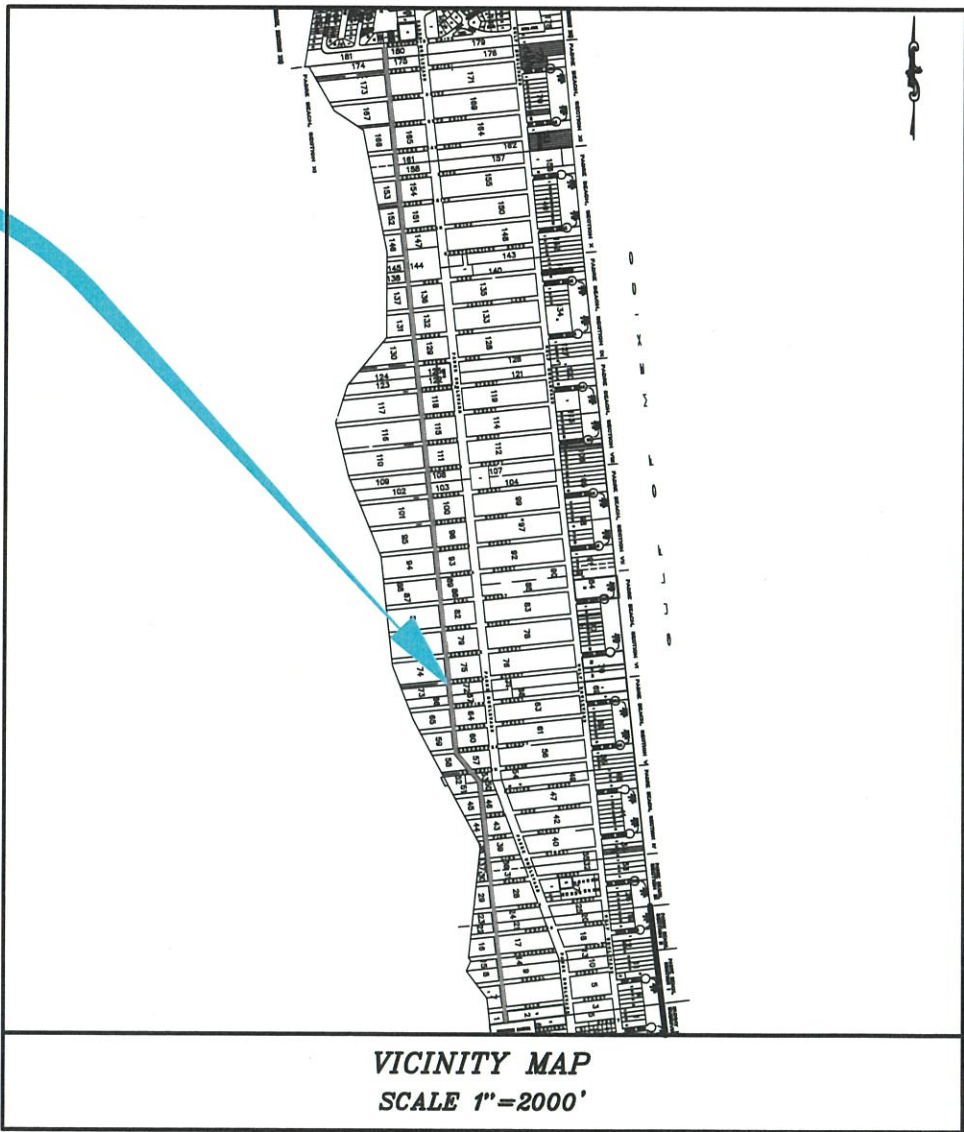

VICINITY MAP
SCALE 1"=2000'

SOUTH PADRE ISLAND CITY COUNCIL

- | | |
|---------------|------------------|
| MAYOR | PATRICK McNULTY |
| MAYOR PRO-TEM | JOE RICCO |
| MEMBER | KEN MEDDERS, JR. |
| MEMBER | LISA GRAVES |
| MEMBER | REES LANGSTON |
| MEMBER | KERRY SCHWARTZ |



IN
SOUTH PADRE ISLAND
TEXAS

AUGUST 19, 2024

LAGUNA BOULEVARD STREET & DRAINAGE IMPROVEMENTS		
TITLE SHEET		
PUBLIC WORKS		
4601 PADRE BLVD. SOUTH PADRE ISLAND TEXAS 78597 (956) 761-8158 Fax (956) 761-3898		
SCALE: AS SHOWN	REVISIONS:	SHEET
DRAWN BY: CAS		1
DATE: 08/19/2024		
FILE: LAGUNABLDV-DESIGN5		OF 14

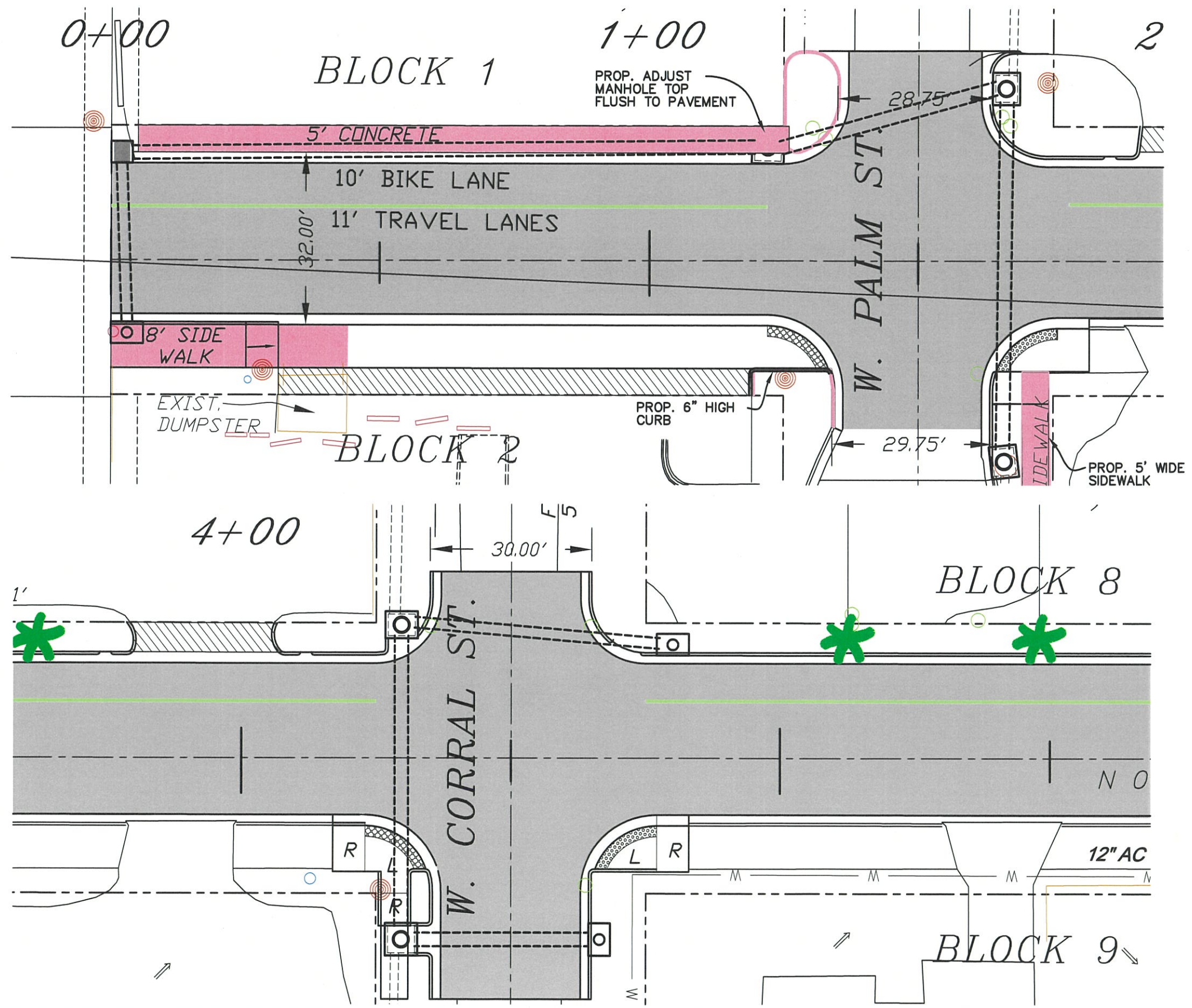

QUANTITIES THIS SHEET		
DESCRIPTION	UNIT	QTY.
SIDEWALK	SY	138
6" HIGH CURB	LF	65
ADJUST MANHOLE TOP	EA	1

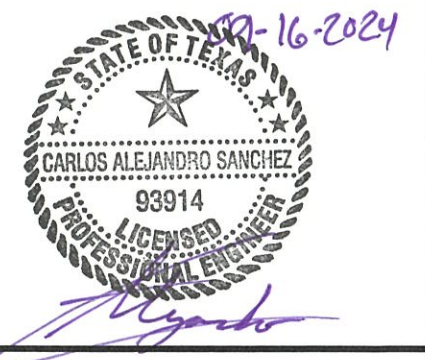

**LAGUNA BOULEVARD
CLORE PUNCHLIST**

**W. MARLIN ST.
DETAIL RAMP GRADING**

PUBLIC WORKS

4601 PADRE BLVD.
SOUTH PADRE ISLAND
TEXAS 78597
(956) 761-8158
Fax (956) 761-3898

SCALE: 1"=20'	REVISIONS:	SHEET
DRAWN BY: CAS		2
DATE: 08/19/2024		OF 14
FILE: LAGUNABLVD-DESIGN5		

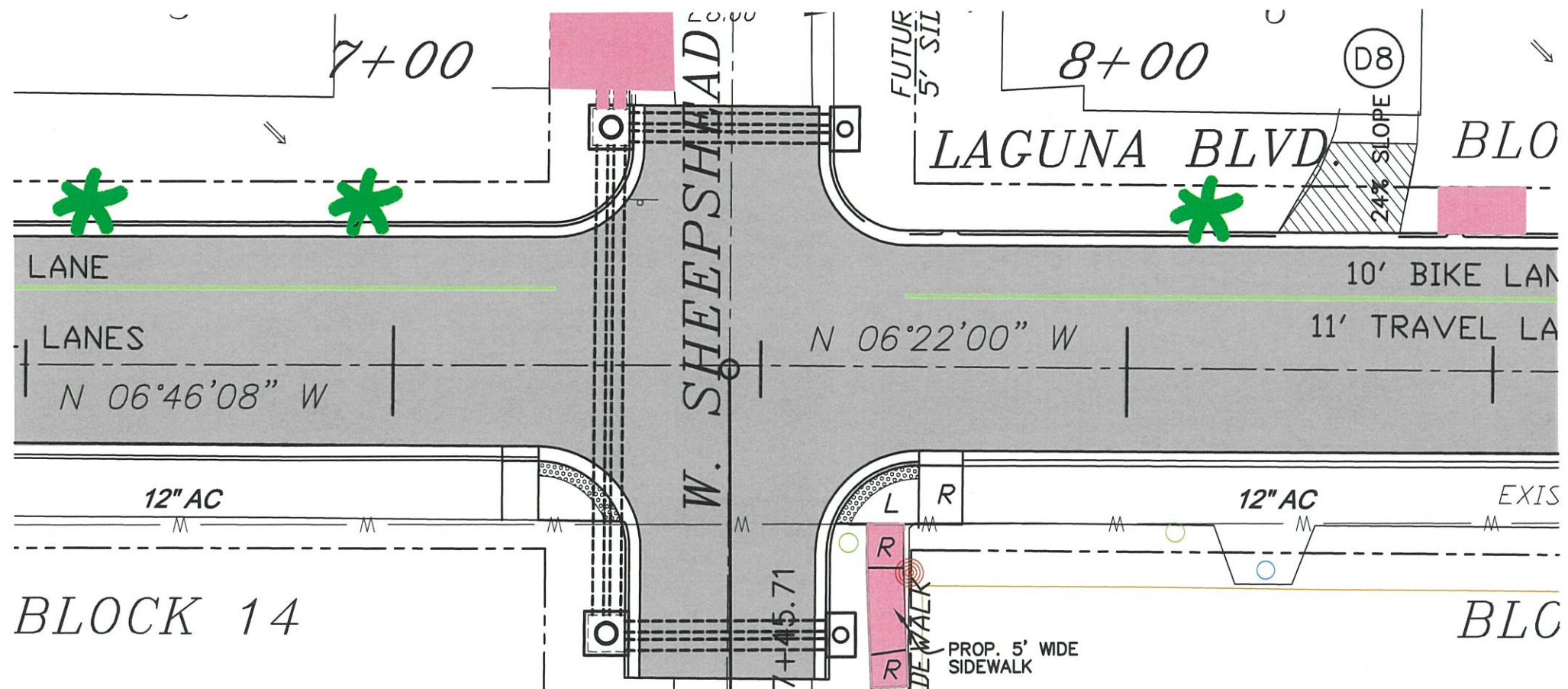

QUANTITIES THIS SHEET

DESCRIPTION	UNIT	QTY.
REMOVE CONC. DRIVEWAY	SY	340
5" THICK CONC. DRIVEWAY	SY	350
SIDEWALK	SY	13
CONNECT EXIST. STORM	EA	1
60" STORM MANHOLE	EA	1
24" RCP	LF	176

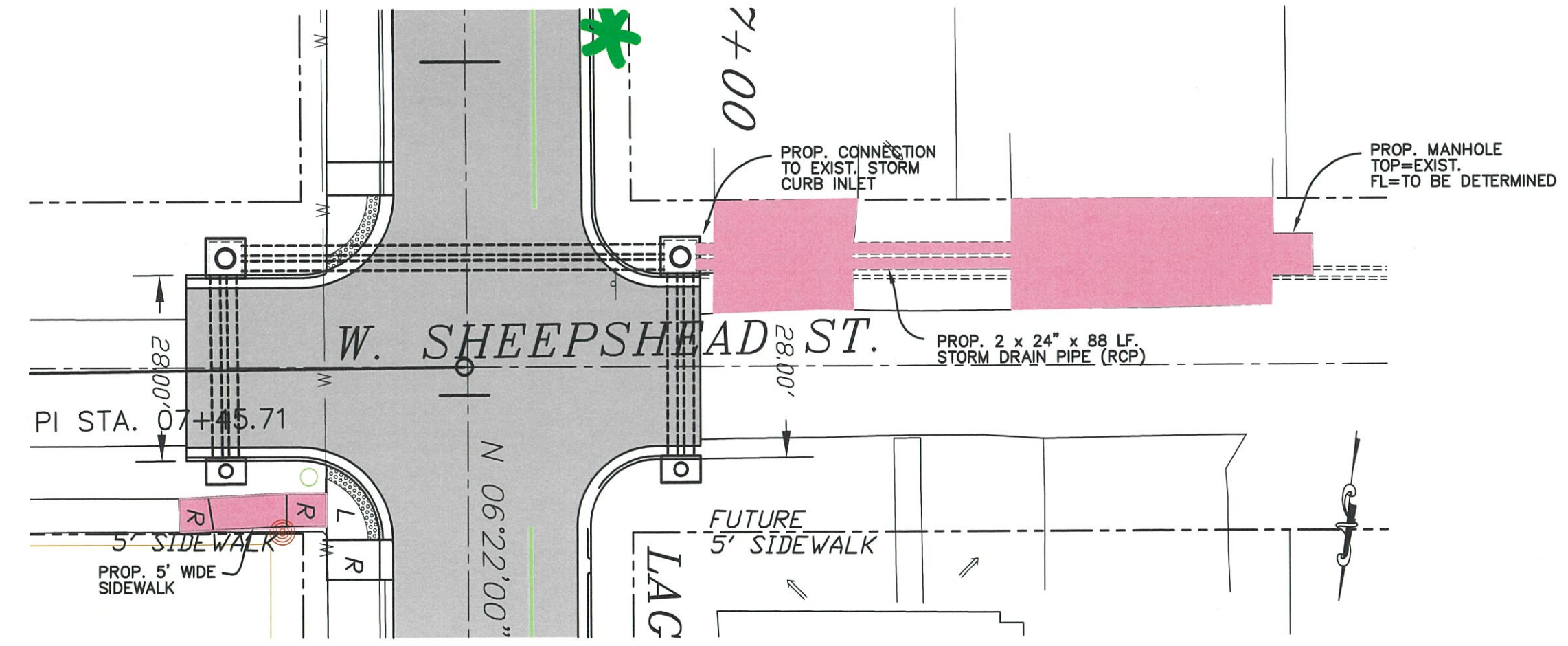

**LAGUNA BOULEVARD
CLORE PUNCHLIST**

**W. MARLIN ST.
DETAIL RAMP GRADING**

PUBLIC WORKS

**4601 PADRE BLVD.
SOUTH PADRE ISLAND
TEXAS 78597
(956) 761-8158
Fax (956) 761-3898**

SCALE: 1"=20'	REVISIONS:	SHEET
DRAWN BY: CAS		3
DATE: 08/19/2024		OF 14
FILE: LAGUNABLVD-DESIGN5		

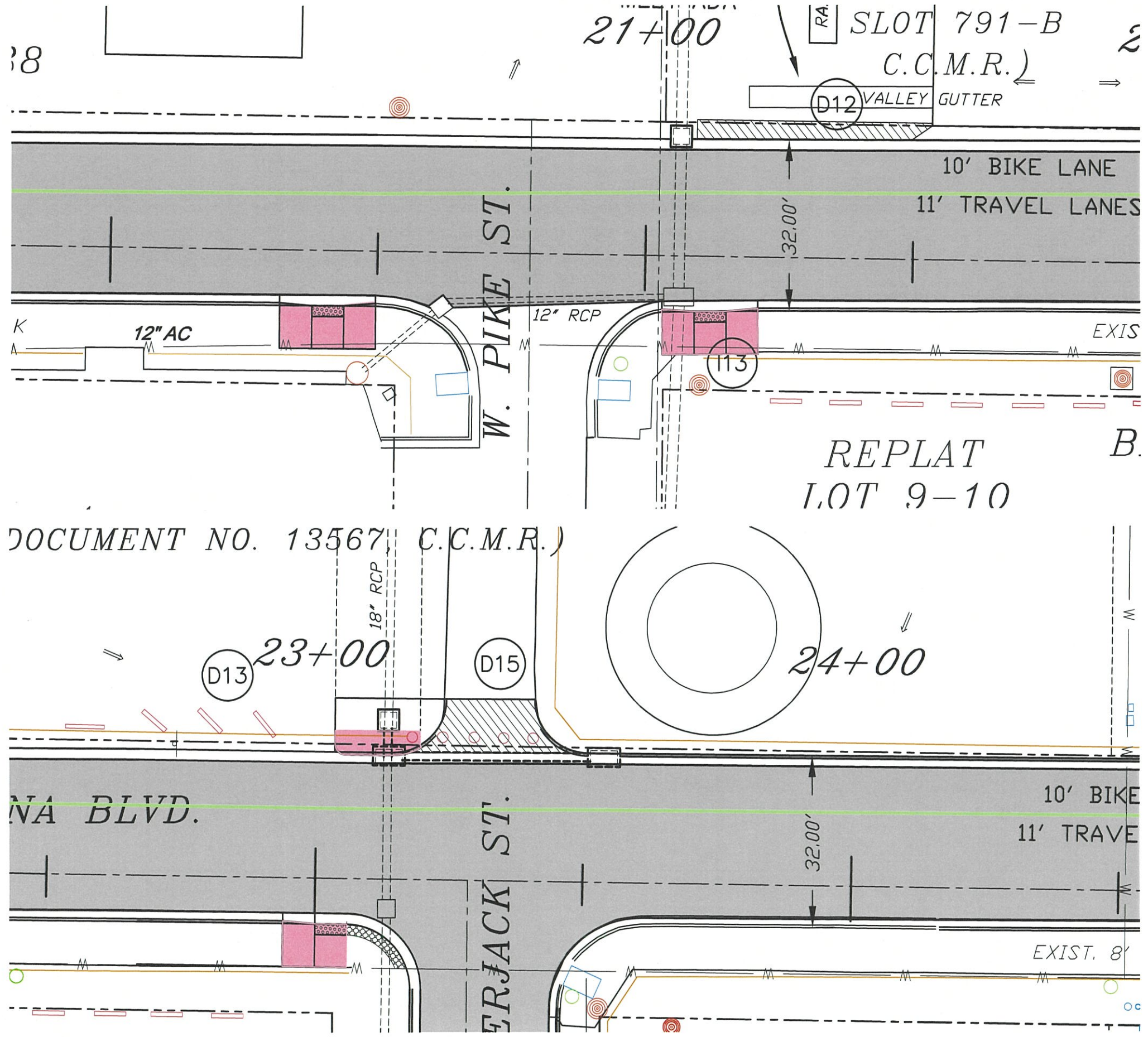

QUANTITIES THIS SHEET

DESCRIPTION	UNIT	QTY.
REMOVE CONC. SIDEWALK	SY	38
HANDICAP RAMP TYPE 2	EA	2
HANDICAP RAMP TYPE 10	EA	1
5" THICK CONCRETE	SY	8



**LAGUNA BOULEVARD
CLORE PUNCHLIST**

**W. MARLIN ST.
DETAIL RAMP GRADING**

PUBLIC WORKS

**4601 PADRE BLVD,
SOUTH PADRE ISLAND
TEXAS 78597
(956) 761-8158
Fax (956) 761-3898**

SCALE: 1"=20'	REVISIONS:	SHEET
DRAWN BY: CAS		5
DATE: 08/19/2024		OF 14
FILE: LAGUNABLVD-DESIGN5		

SKIPJACK BAYFRONT
(DOCUMENT NO. 13567, C.C.M.R.)

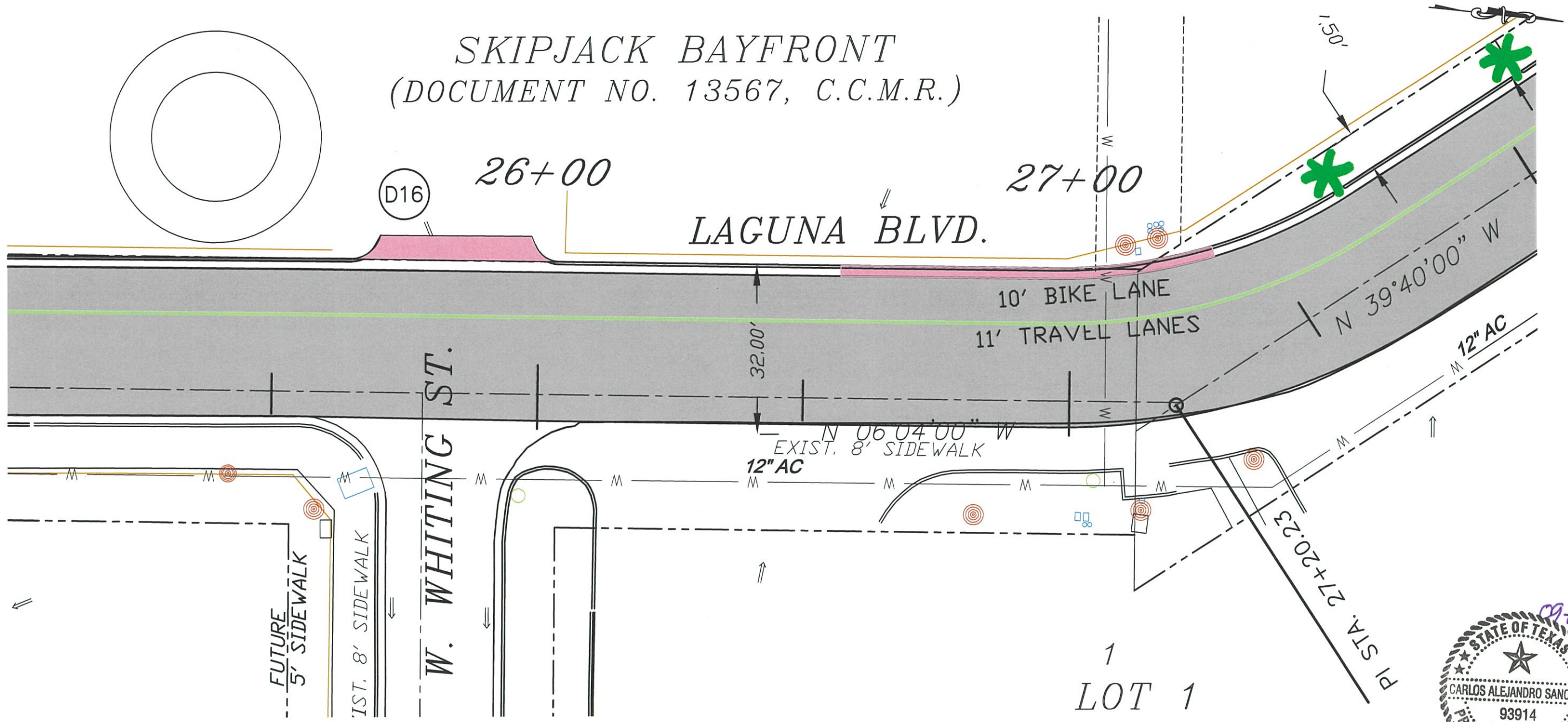

QUANTITIES THIS SHEET		
DESCRIPTION	UNIT	QTY.
2" ASPHALT DRIVEWAY	SY	16
REMOVE CURB & GUTTER	LF	80
CURB & GUTTER	LF	80



**LAGUNA BOULEVARD
CLORE PUNCHLIST**

**W. MARLIN ST.
DETAIL RAMP GRADING**

PUBLIC WORKS

South Padre Island
4601 PADRE BLVD.
SOUTH PADRE ISLAND
TEXAS 78597
(956) 761-8158
Fax (956) 761-3898

SCALE: 1"=20'	REVISIONS:	SHEET
DRAWN BY: CAS		6
DATE: 08/19/2024		OF 14
FILE: LAGUNABLVD-DESIGN5		



QUANTITIES THIS SHEET		
DESCRIPTION	UNIT	QTY.
2" HMAC	SY	65
METAL POSTS	EA	5

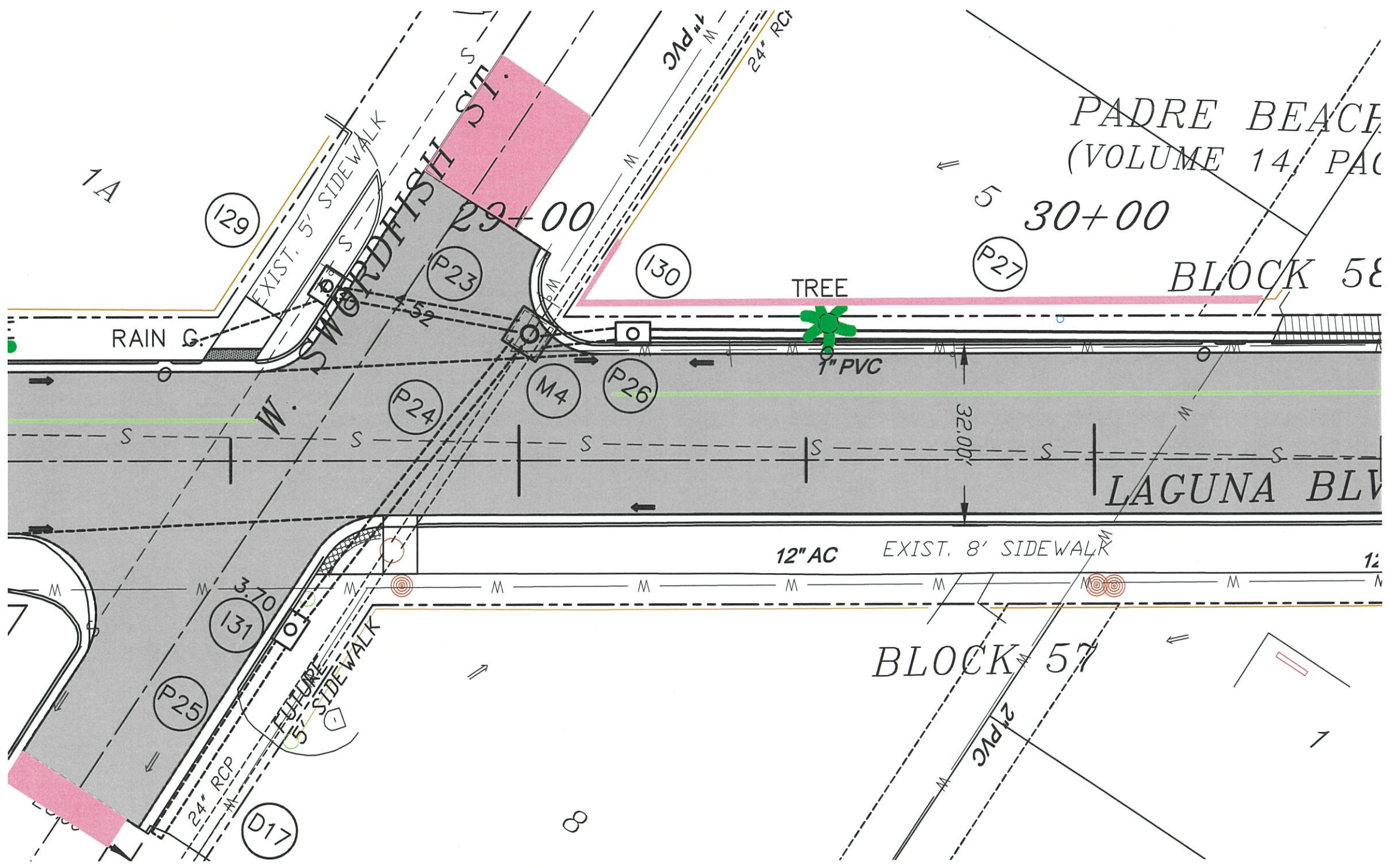

PADRE BEACH
(VOLUME 14, PAC)

BLOCK 58

LAGUNA BLVD

BLOCK 57

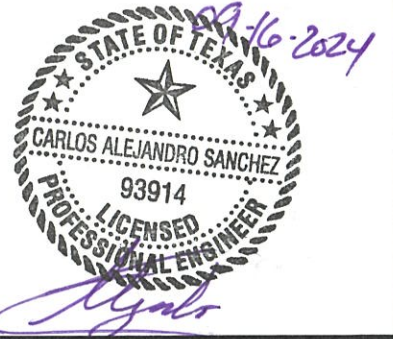

LAGUNA BOULEVARD CLORE FUNCLIST	
W. MARLIN ST. DETAIL RAMP GRADING	
PUBLIC WORKS	
4601 PADRE BLVD, SOUTH PADRE ISLAND TEXAS 78697 (956) 761-8158 Fax (956) 761-3898	
SCALE: 1"=20'	REVISIONS: SHEET
DRAWN BY: CAS	7
DATE: 08/19/2024	
FILE: LAGUNABLDV-DESIGN5	OF 14

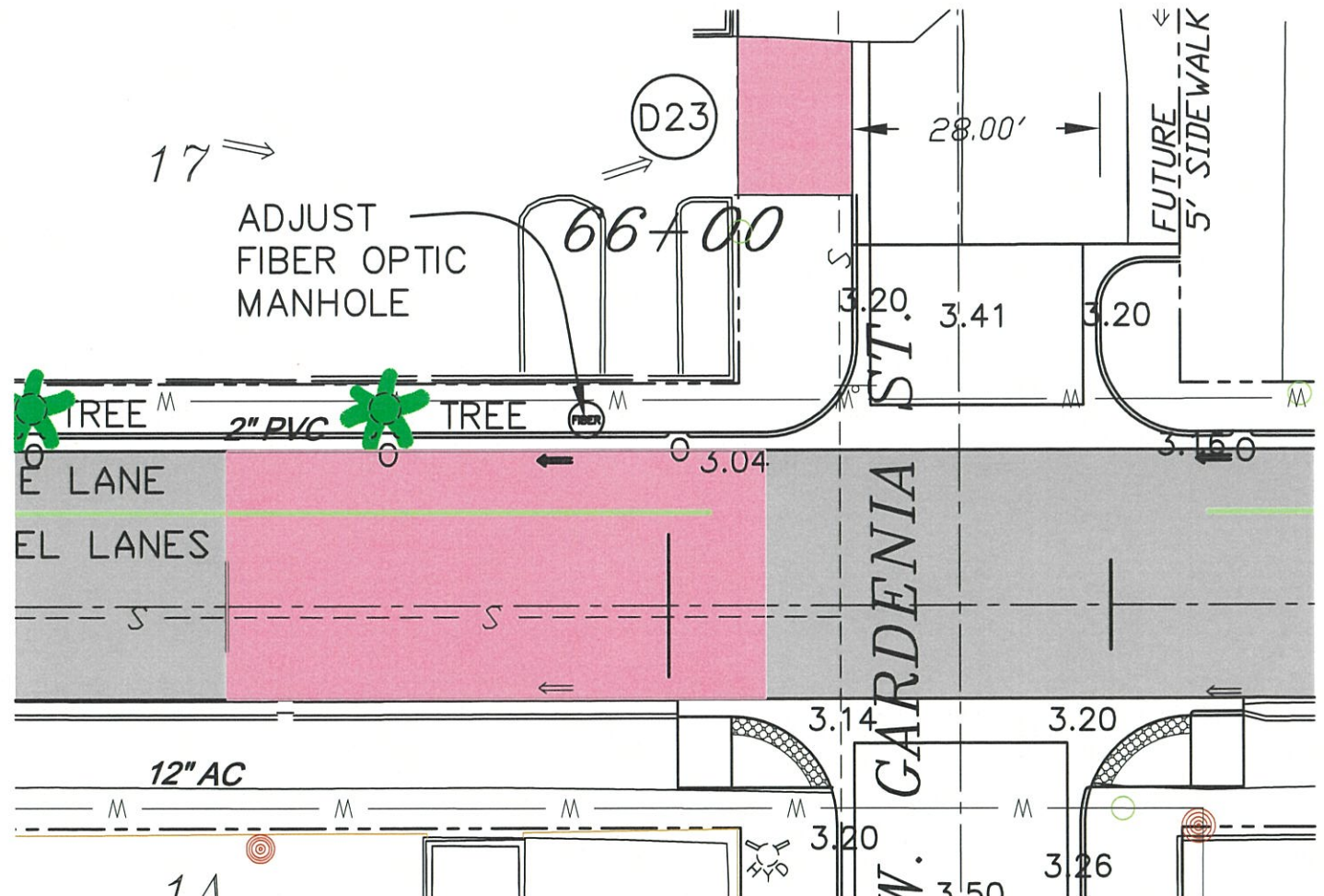
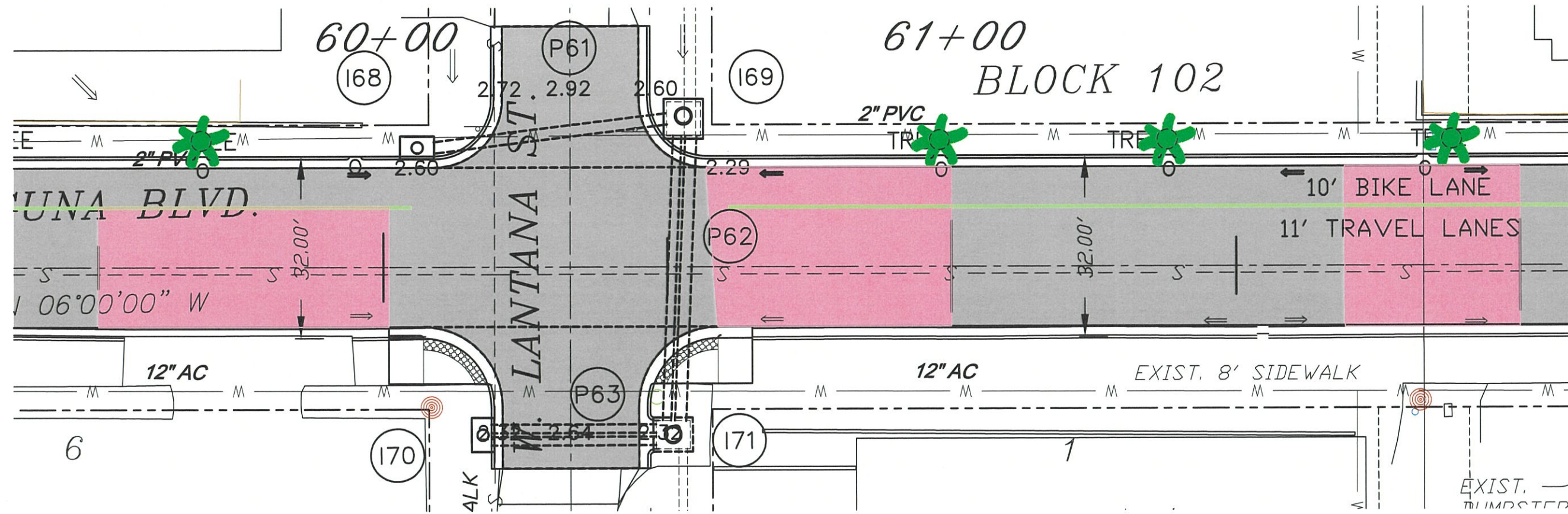

QUANTITIES THIS SHEET

DESCRIPTION	UNIT	QTY.
MILL & OVERLAY - 2"	SY	290
REMOVE CONCRETE DRIVE	SY	26
CONCRETE DRIVEWAY	SY	26
CURB & GUTTER	LF	18

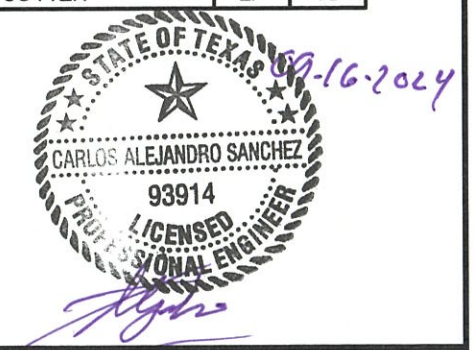

**LAGUNA BOULEVARD
CLORE PUNCHLIST**

**W. MARLIN ST.
DETAIL RAMP GRADING**

PUBLIC WORKS

South Padre Island
4601 PADRE BLVD,
SOUTH PADRE ISLAND
TEXAS 78597
(956) 761-8158
Fax (956) 761-3898

SCALE: 1"=20'	REVISIONS:	SHEET
DRAWN BY: CAS		10
DATE: 08/19/2024		OF 14
FILE: LAGUNABLVD-DESIGN5		

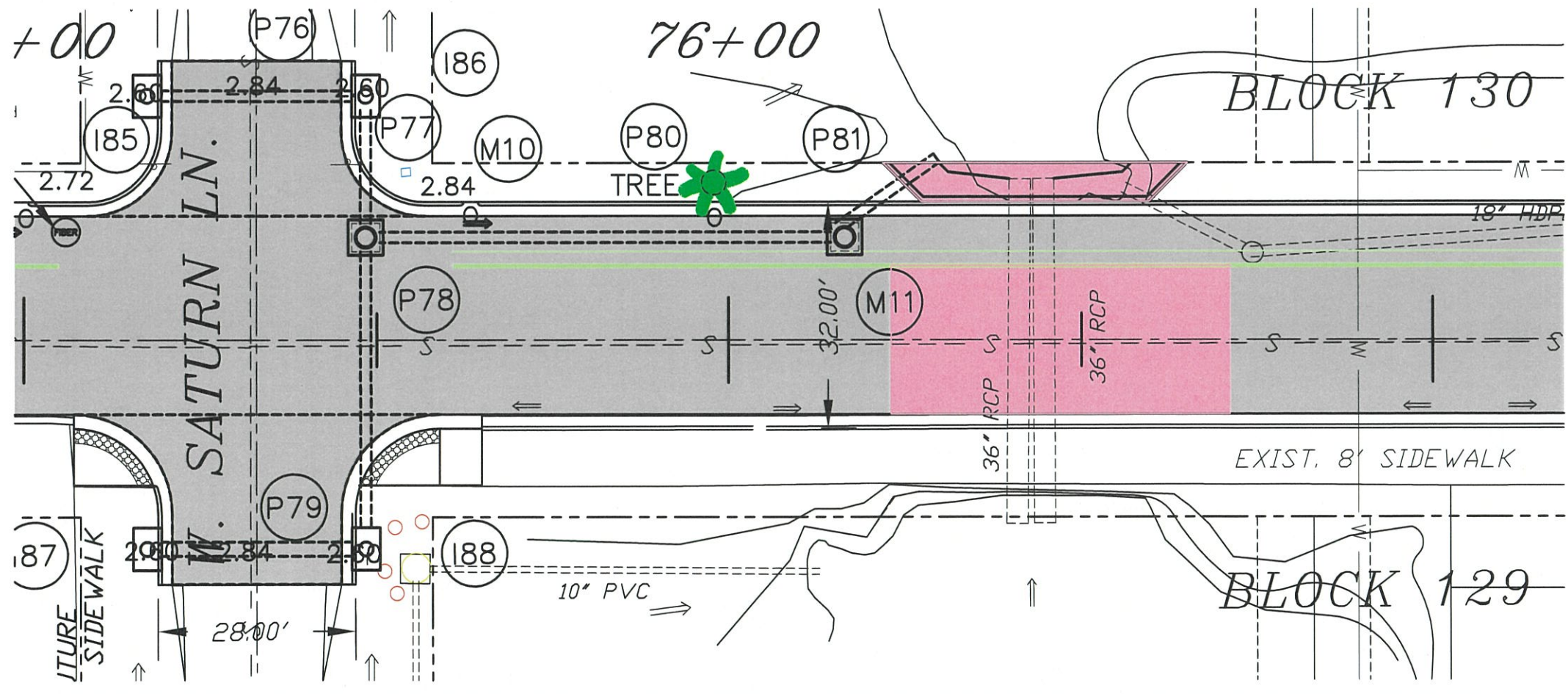
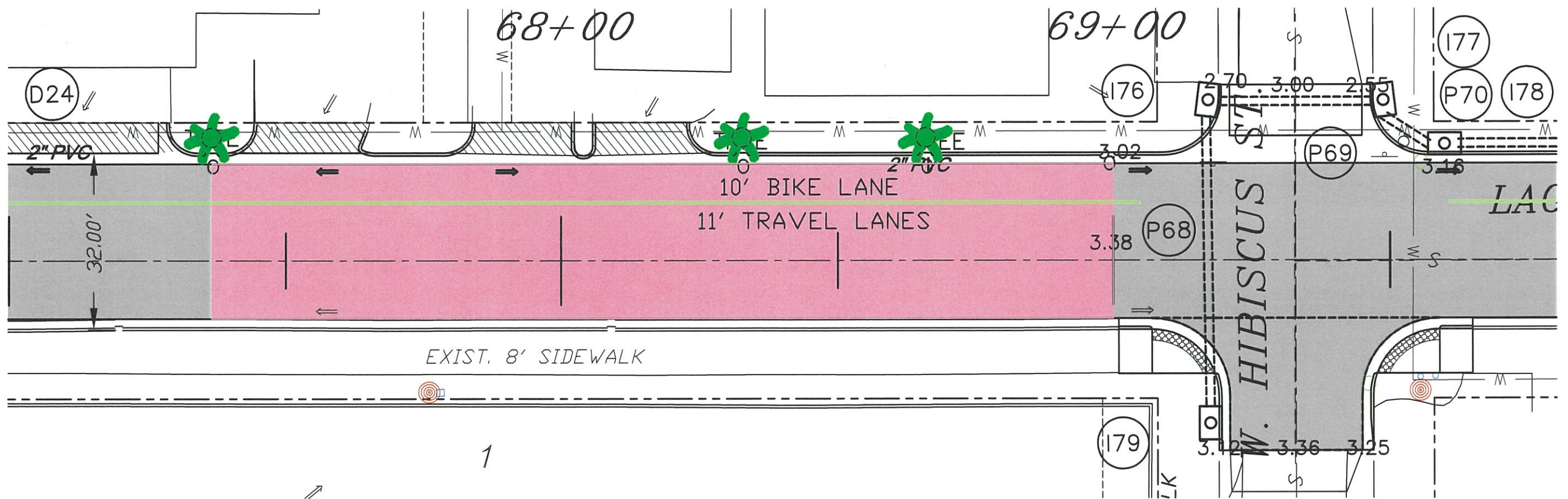

QUANTITIES THIS SHEET		
DESCRIPTION	UNIT	QTY.
MILL & OVERLAY - 2"	SY	620
6' HIGH HEADWALL	LF	32

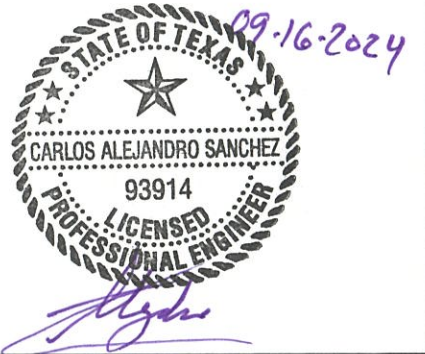

**LAGUNA BOULEVARD
CLORE PUNCHLIST**

**W. MARLIN ST.
DETAIL RAMP GRADING**

PUBLIC WORKS

4601 PADRE BLVD,
SOUTH PADRE ISLAND
TEXAS 78697
(956) 761-8158
Fax (956) 761-3898

SCALE: 1"=20'	REVISIONS:	SHEET
DRAWN BY: CAS		11
DATE: 08/19/2024		OF 14
FILE: LAGUNABLVD-DESIGN5		

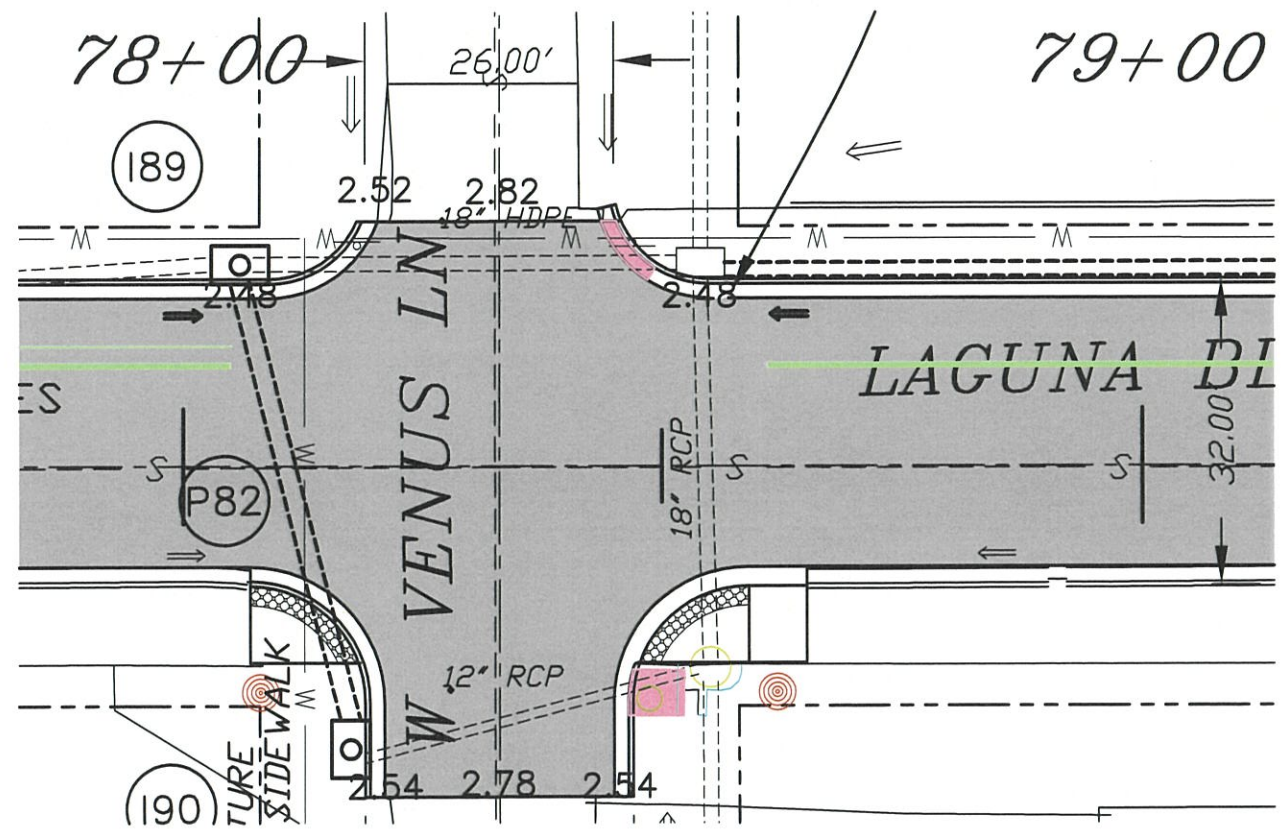

QUANTITIES THIS SHEET		
DESCRIPTION	UNIT	QTY.
ROADSIDE DITCH	LF	10
MILL & OVERLAY 2"	SY	82

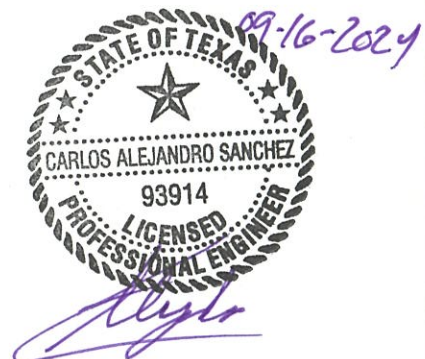
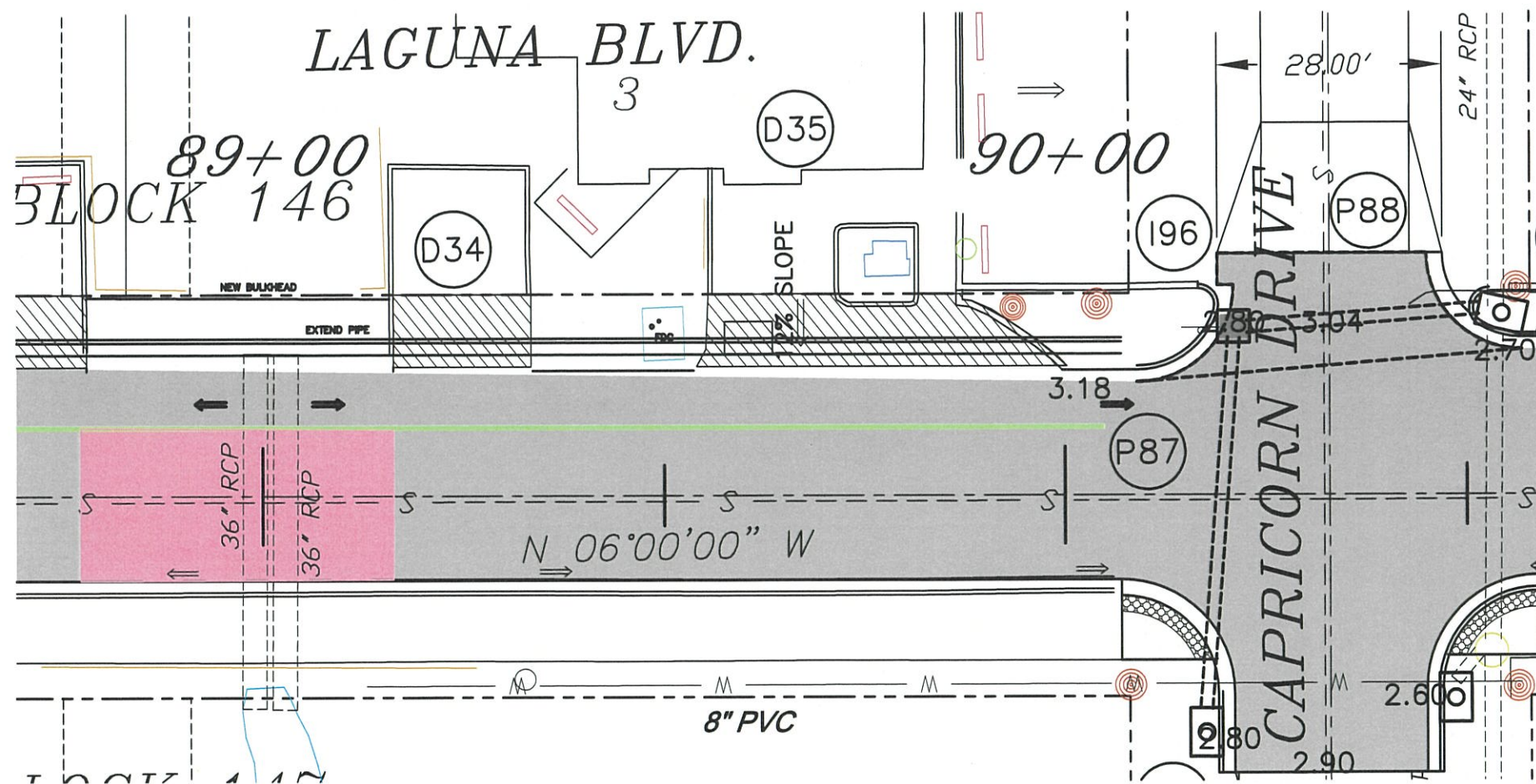

**LAGUNA BOULEVARD
CLORE PUNCHLIST**

**W. MARLIN ST.
DETAIL RAMP GRADING**

PUBLIC WORKS

4601 PADRE BLVD,
SOUTH PADRE ISLAND
TEXAS 78597
(956) 761-8158
Fax (956) 761-3898

SCALE: 1"=20'	REVISIONS:	SHEET
DRAWN BY: CAS		12
DATE: 08/19/2024		OF 14
FILE: LAGUNABLVD-DESIGN5		

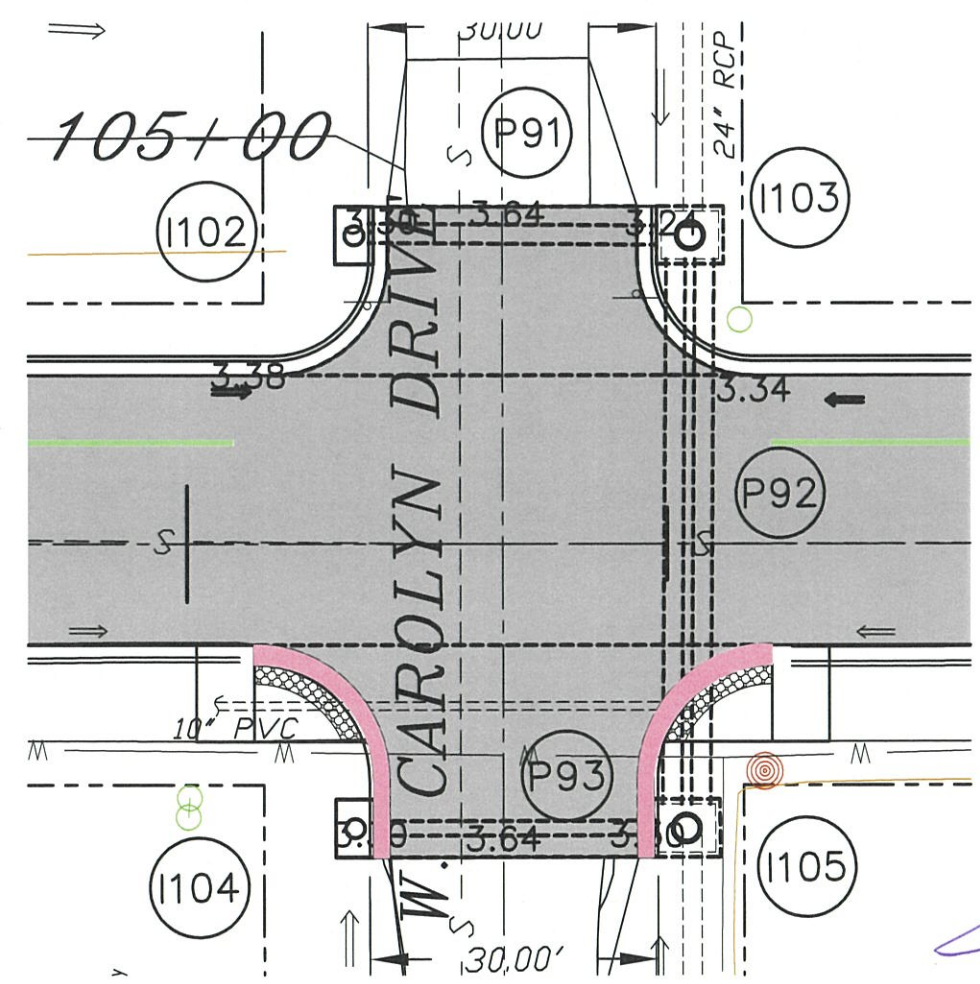
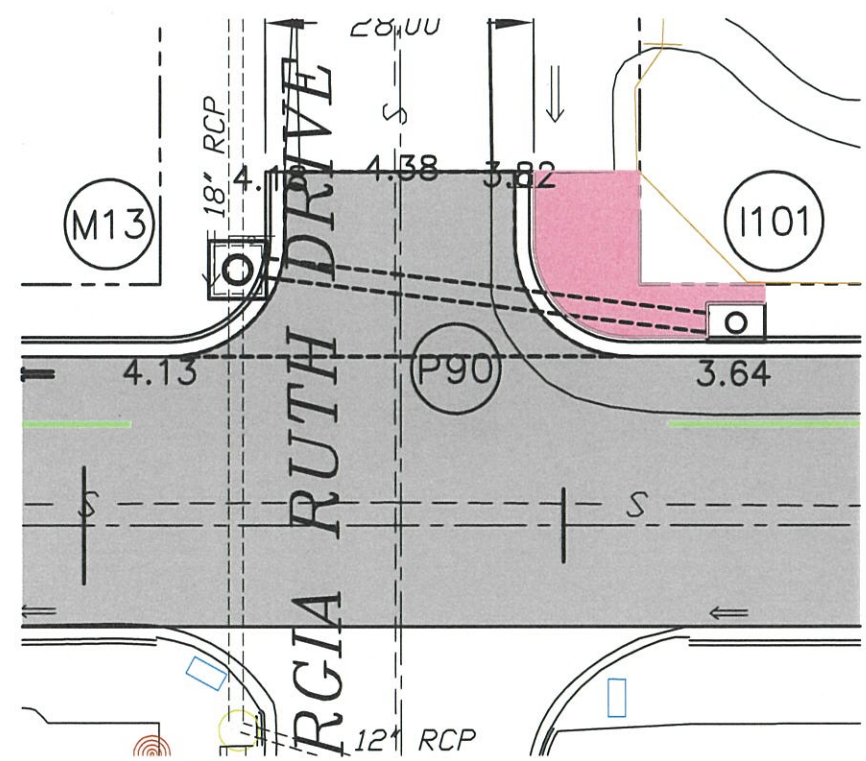
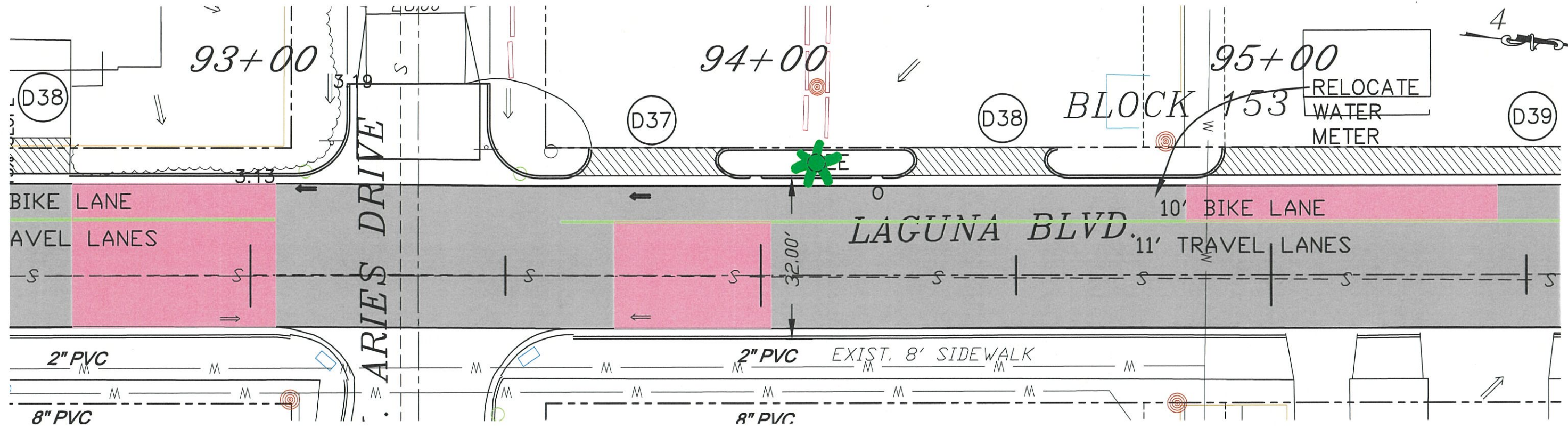

QUANTITIES THIS SHEET		
DESCRIPTION	UNIT	QTY.
MILL & OVERLAY - 2"	SY	48
REMOVE CONCRETE AREA	SY	25
VALLEY GUTTER	SY	25
REMOVE CURB & GUTTER	LF	60
CURB & GUTTER	LF	60



09-16-2024
[Signature]

**LAGUNA BOULEVARD
CLORE PUNCHLIST**

**W. MARLIN ST.
DETAIL RAMP GRADING**

PUBLIC WORKS

4801 PADRE BLVD,
SOUTH PADRE ISLAND
TEXAS 78697
(956) 761-8158
Fax (956) 761-3898

SCALE: 1"=20'	REVISIONS:	SHEET
DRAWN BY: CAS		13
DATE: 08/19/2024		OF 14
FILE: LAGUNABLVD-DESIGN5		

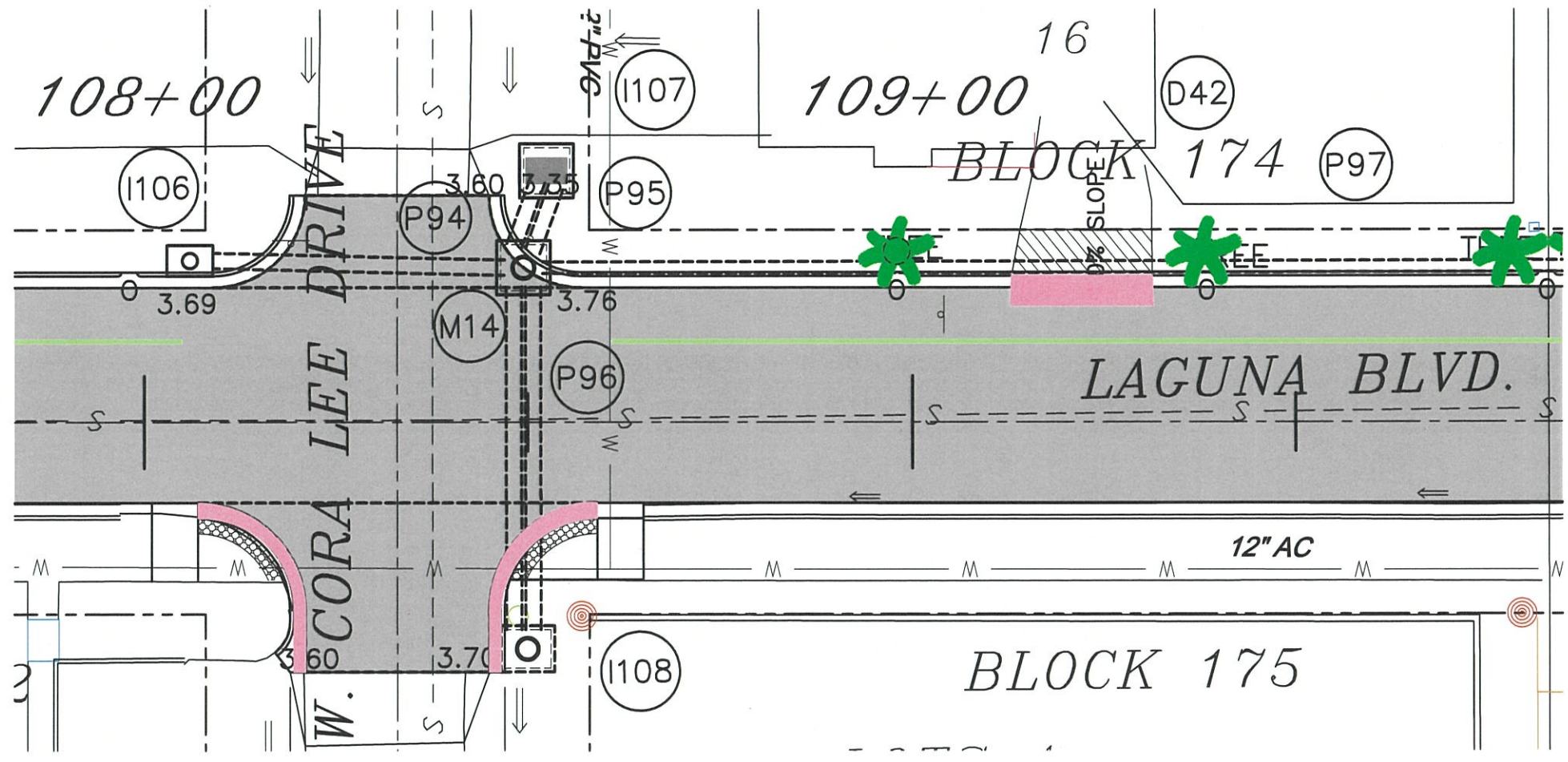

QUANTITIES THIS SHEET

DESCRIPTION	UNIT	QTY.
MILL & OVERLAY - 2"	SY	8
REMOVE CURB & GUTTER	LF	60
CURB & GUTTER	LF	60

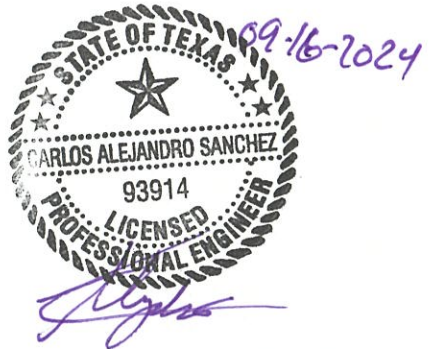

**LAGUNA BOULEVARD
CLORE PUNCHLIST**

**W. MARLIN ST.
DETAIL RAMP GRADING**



**South Padre
ISLAND**

PUBLIC WORKS

4601 PADRE BLVD,
SOUTH PADRE ISLAND
TEXAS 78597
(956) 761-8158
Fax (956) 761-3898

SCALE: 1"=20'	REVISIONS:	SHEET
DRAWN BY: CAS		14
DATE: 08/19/2024		OF 14
FILE: LAGUNABLDV-DESIGN5		

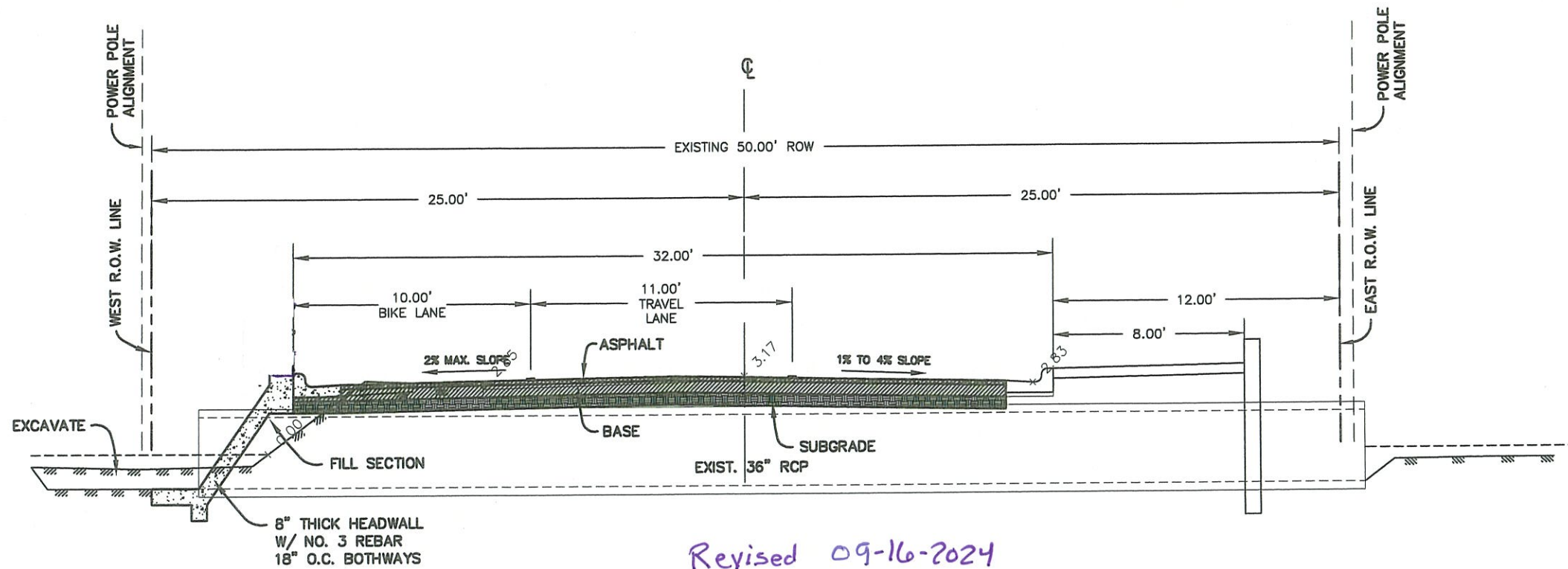

Revised 09-16-2024

EXISTING
CULVERT CROSSING

SCALE: 1/8" = 1'

STA. 76+50

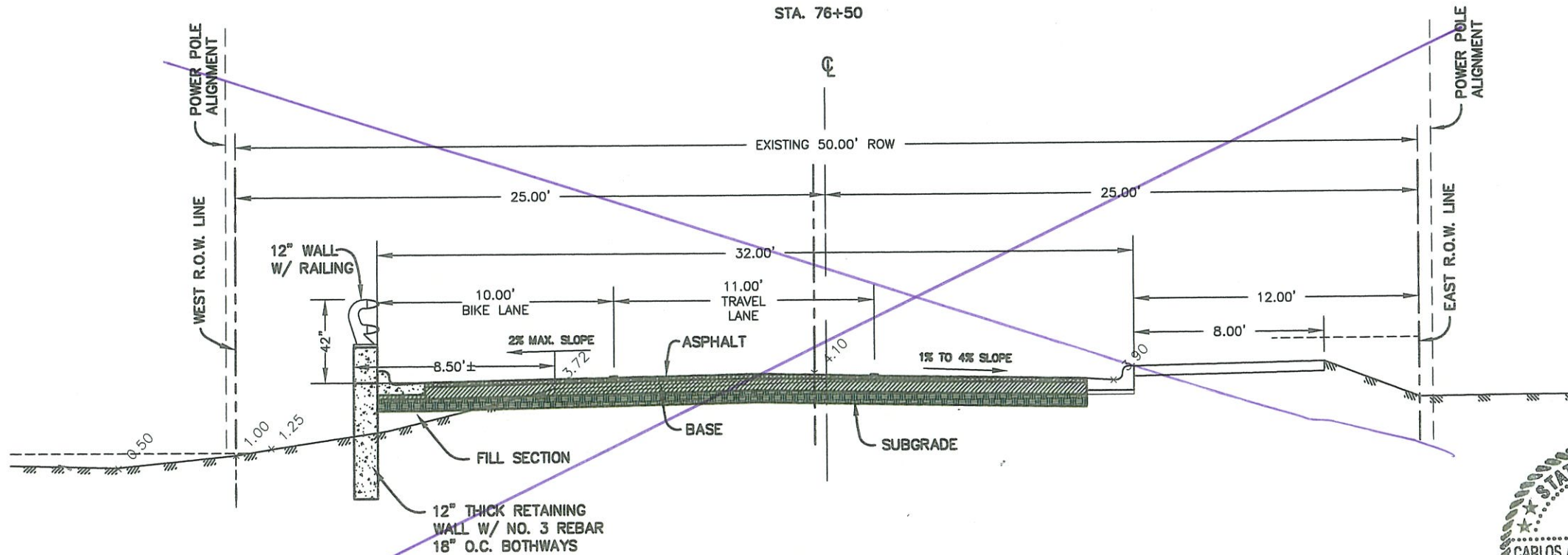

~~PROPOSED~~
~~WETLAND CROSSING~~

SCALE: 1/8" = 1'

STA. 101+00



CAS
10-19-2021

LAGUNA BOULEVARD
STREET & DRAINAGE IMPROVEMENTS

PROPOSED DRAINAGE CROSS-SECTIONS

PUBLIC WORKS

South Padre Island

4601 PADRE BLVD,
SOUTH PADRE ISLAND
TEXAS 78597
(956) 761-8158
Fax (956) 761-3898

SCALE: AS SHOWN	REVISIONS:	SHEET
DRAWN BY: CAS		19
DATE: 10/19/2021		OF 115
FILE: LAGUNABI VD-DESIGN4		

DISCLAIMER: The use of this standard is governed by the "Texas Engineering Practice Act". No warranty of any kind is made by TxDOT for any purpose whatsoever. TxDOT assumes no responsibility for the conversion of this standard to other formats or for incorrect results or damages resulting from its use.

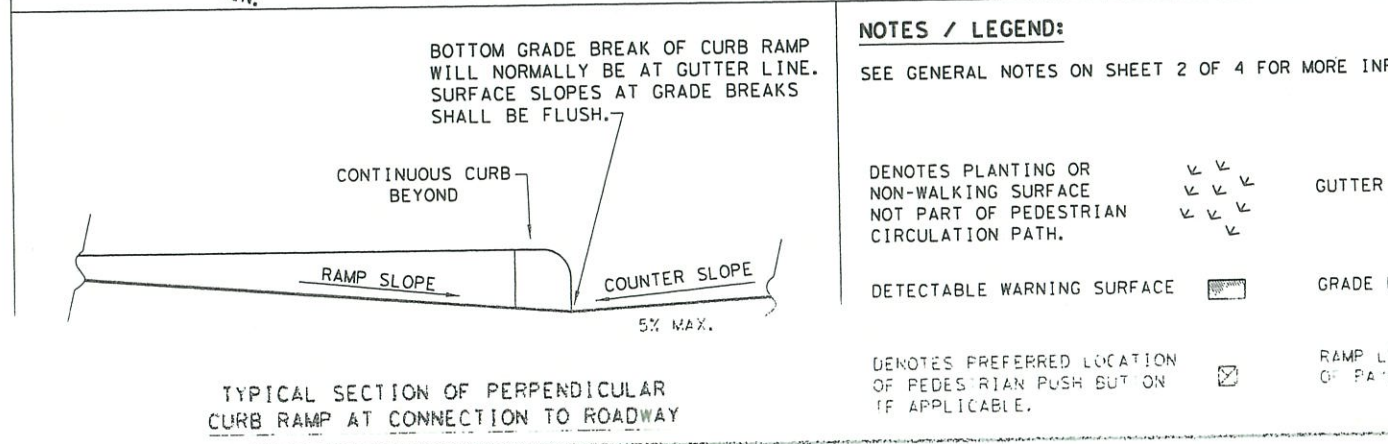
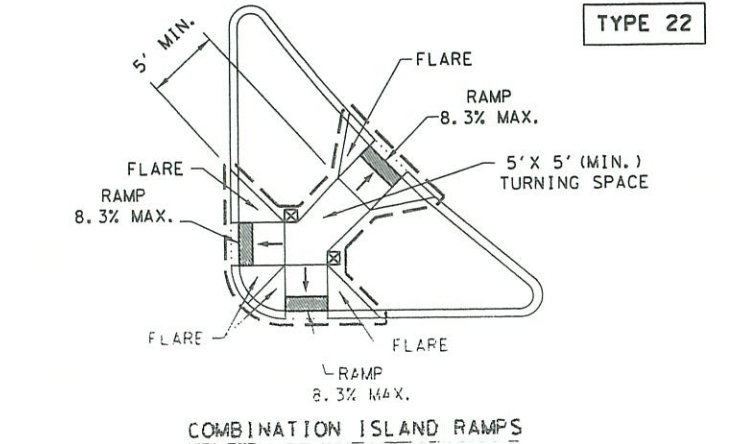
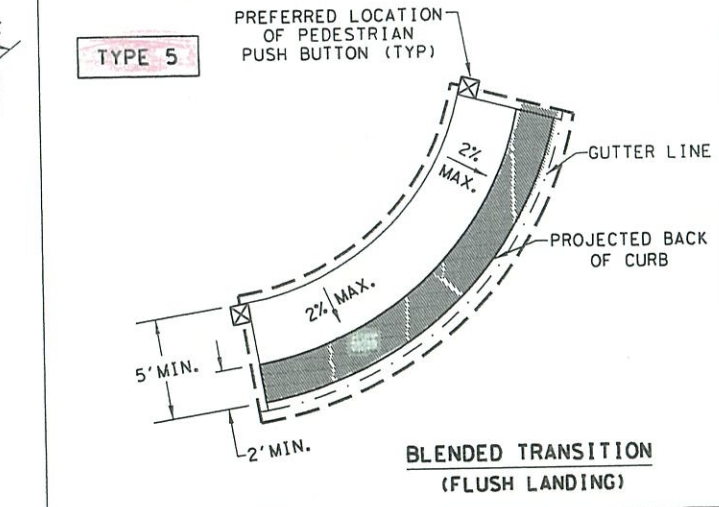
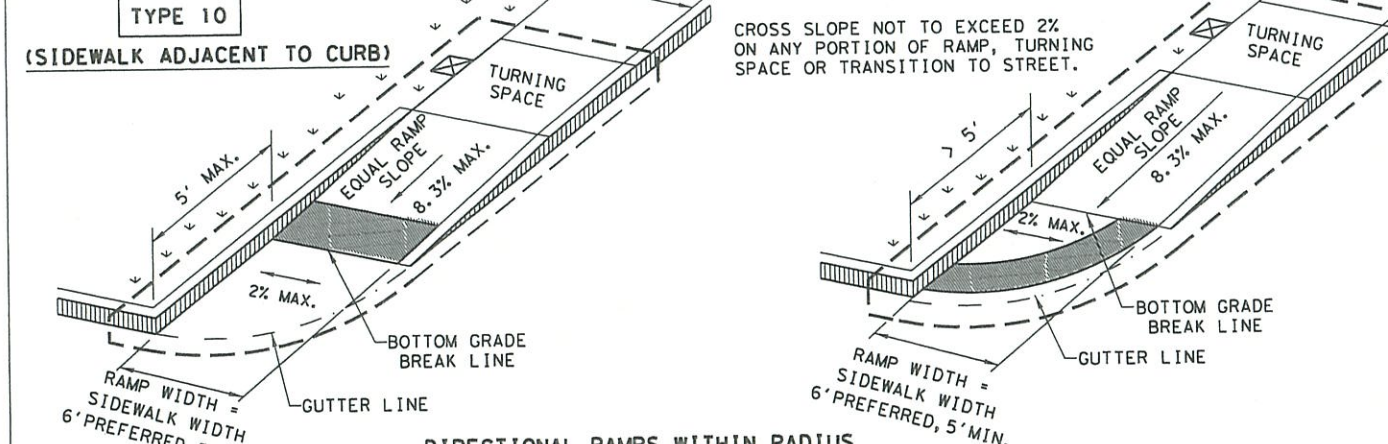
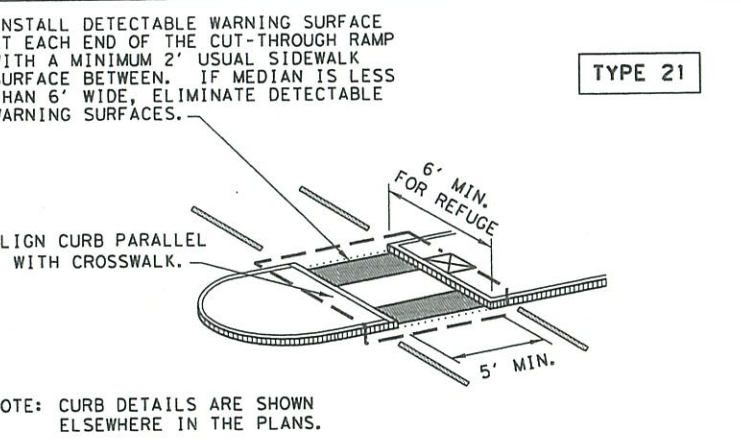
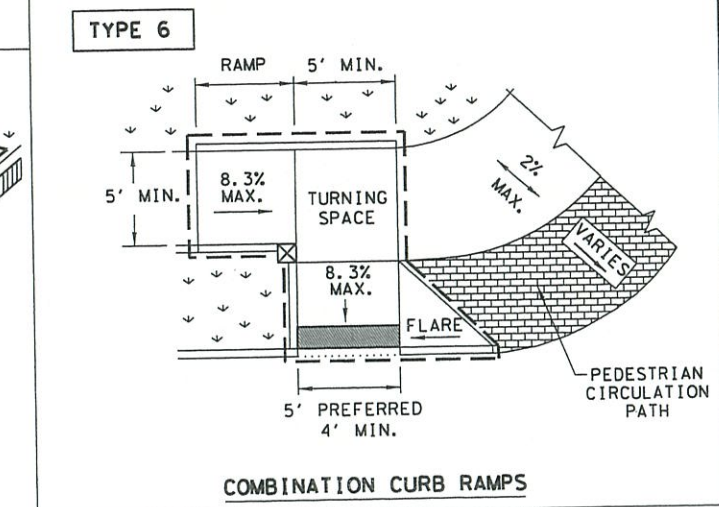
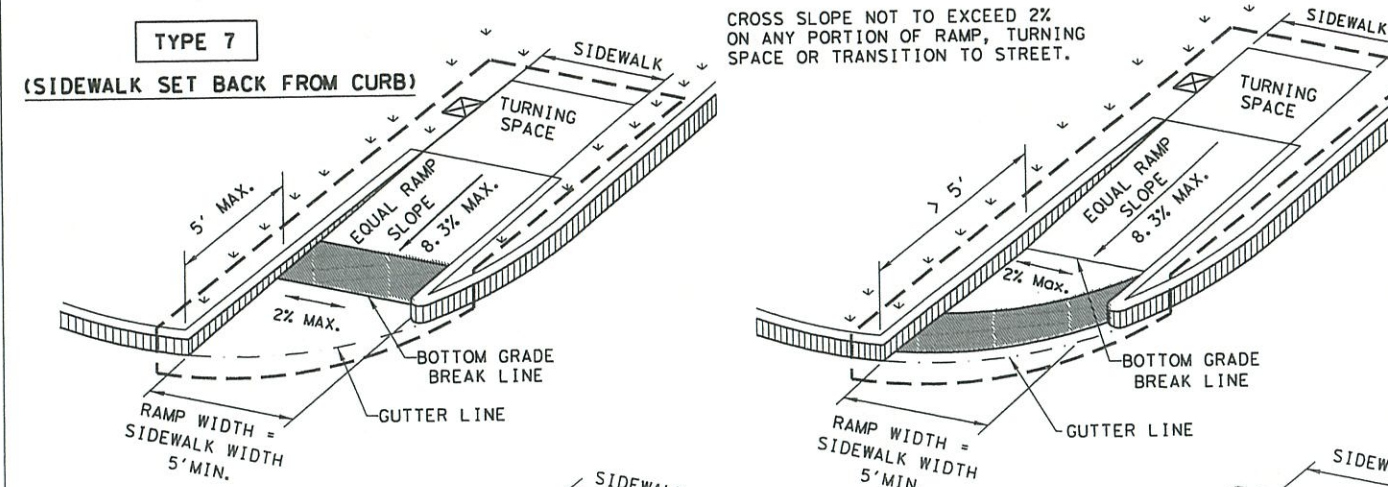
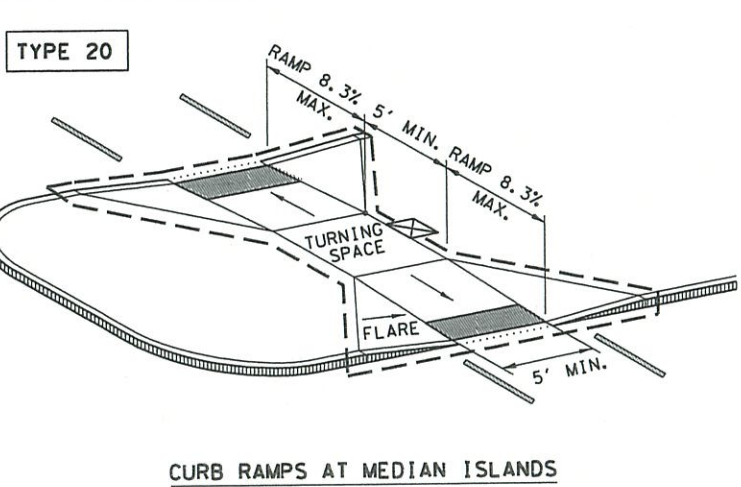
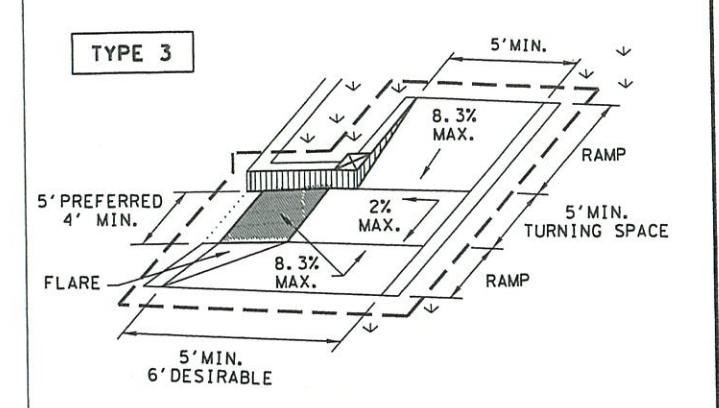
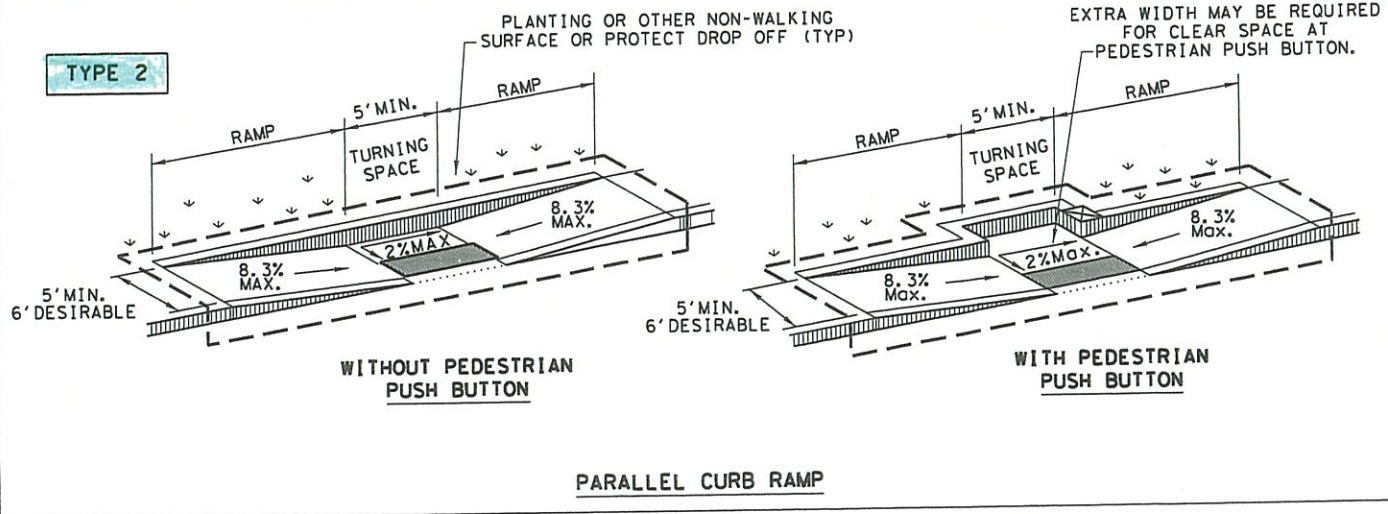
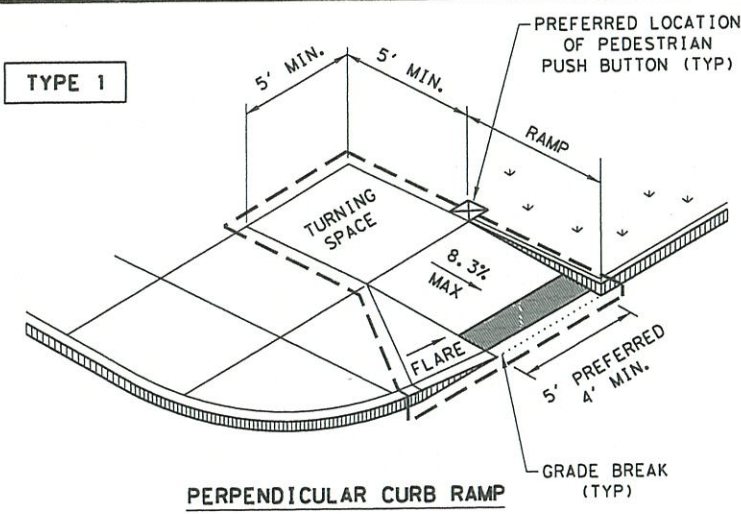

SHEET 1 OF 4

Texas Department of Transportation Design Division Standard

PEDESTRIAN FACILITIES CURB RAMPS

PED-18

NOTES / LEGEND:

SEE GENERAL NOTES ON SHEET 2 OF 4 FOR MORE INFORMATION.

DENOTES PLANTING OR NON-WALKING SURFACE NOT PART OF PEDESTRIAN CIRCULATION PATH.

DENOTES PREFERRED LOCATION OF PEDESTRIAN PUSH BUTTON IF APPLICABLE.

GUTTER LINE

GRADE BREAK

RAMP LIMITS OF PAVEMENT

DEC 8

© TxDOT, MARCH 2002

REVISED 08/2005

REVISED 11/2007

REVISED 07/2014

72

DISCLAIMER: The use of this standard is governed by the "Texas Engineering Practice Act". No warranty of any kind is made by TxDOT for any purpose whatsoever. TxDOT assumes no responsibility for the conversion of this standard to other formats or for incorrect results or damages resulting from its use.

GENERAL NOTES

CURB RAMPS

1. Install a curb ramp or blended transition at each pedestrian street crossing.
2. All slopes shown are maximum allowable. Cross slopes of 1.5% and lesser running should be used. Adjust curb ramp length or grade of approach sidewalks as directed.
3. Maximum allowable cross slope on sidewalk and curb ramp surfaces is 2%.
4. The minimum sidewalk width is 5'. Where the sidewalk is adjacent to the back of curb, a 6' sidewalk width is desirable. Where a 5' sidewalk cannot be provided due to site constraints, sidewalk width may be reduced to 4' for short distances. 5' x 5' passing areas at intervals not to exceed 200' are required.
5. Turning Spaces shall be 5' x 5' minimum. Cross slope shall be maximum 2%.
6. Clear space at the bottom of curb ramps shall be a minimum of 4' x 4' wholly contained within the crosswalk and wholly outside the parallel vehicular travel path.
7. Provide flared sides where the pedestrian circulation path crosses the curb ramp. Flared sides shall be sloped at 10% maximum, measured parallel to the curb. Returned curbs may be used only where pedestrians would not normally walk across the ramp, either because the adjacent surface is planted, substantially obstructed, or otherwise protected.
8. Additional information on curb ramp location, design, light reflective value and texture may be found in the latest draft of the Proposed Guidelines for Pedestrian Facilities in the Public Right of Way (PROWAG) as published by the U.S. Architectural and Transportation Barriers Compliance Board (Access Board).
9. To serve as a pedestrian refuge area, the median should be a minimum of 6' wide, measured from back of curbs. Medians should be designed to provide accessible passage over or through them.
10. Small channelization islands, which do not provide a minimum 5' x 5' landing at the top of curb ramps, shall be cut through level with the surface of the street.
11. Crosswalk dimensions, crosswalk markings and stop bar locations shall be as shown elsewhere in the plans. At intersections where crosswalk markings are not required, curb ramps shall align with theoretical crosswalks unless otherwise directed.
12. Provide curb ramps to connect the pedestrian access route at each pedestrian street crossing. Handrails are not required on curb ramps.
13. Curb ramps and landings shall be constructed and paid for in accordance with Item 531 "Sidewalks".
14. Place concrete at a minimum depth of 5" for ramps, flares and landings, unless otherwise directed.
15. Furnish and install No. 3 reinforcing steel bars at 18" o.c. both ways, unless otherwise directed.
16. Provide a smooth transition where the curb ramps connect to the street.
17. Curbs shown on sheet 1 within the limits of payment are considered part of the curb ramp for payment, whether it is concrete curb, gutter, or combined curb and gutter.
18. Existing features that comply with applicable standards may remain in place unless otherwise shown on the plans.

DETECTABLE WARNING MATERIAL

19. Curb ramps must contain a detectable warning surface that consists of raised truncated domes complying with PROWAG. The surface must contrast visually with adjoining surfaces, including side flares. Furnish and install an approved cast-in-place dark brown or dark red detectable warning surface material adjacent to uncolored concrete, unless specified elsewhere in the plans.
20. Detectable Warning Materials must meet TxDOT Departmental Materials Specification DMS 4350 and be listed on the Material Producer List. Install products in accordance with manufacturer's specifications.
21. Detectable warning surfaces must be firm, stable and slip resistant.
22. Detectable warning surfaces shall be a minimum of 24 inches in depth in the direction of pedestrian travel, and extend the full width of the curb ramp or landing where the pedestrian access route enters the street.
23. Detectable warning surfaces shall be located so that the edge nearest the curb line is at the back of curb and neither end of that edge is greater than 5 feet from the back of curb. Detectable warning surfaces may be curved along the corner radius.
24. Shaded areas on Sheet 1 of 4 indicate the approximate location for the detectable warning surface for each curb ramp type.

DETECTABLE WARNING PAVERS (IF USED)

25. Furnish detectable warning paver units meeting all requirements of ASTM C-936, C-33. Lay in a two by two unit basket weave pattern or as directed.
26. Lay full-size units first followed by closure units consisting of at least 25 percent (25%) of a full unit. Cut detectable warning paver units using a power saw.

SIDEWALKS

27. Provide clear ground space at operable parts, including pedestrian push buttons. Operable parts shall be placed within unobstructed reach range specified in PROWAG section R406.
28. Place traffic signal or illumination poles, ground boxes, controller boxes, signs, drainage facilities and other items so as not to obstruct the pedestrian access route or clear ground space.
29. Street grades and cross slopes shall be as shown elsewhere in the plans.
30. Changes in level greater than 1/4 inch are not permitted.
31. The least possible grade should be used to maximize accessibility. The running slope of sidewalks and crosswalks within the public right of way may follow the grade of the parallel roadway. Where a continuous grade greater than five percent (5%) must be provided, handrails may be desirable to improve accessibility. Handrails may also be needed to protect pedestrians from potentially hazardous conditions. If provided, handrails shall comply with PROWAG R409.
32. Handrail extensions shall not protrude into the usable landing area or into intersecting pedestrian routes.
33. Driveways and turnouts shall be constructed and paid for in accordance with Item "Intersections, Driveways and Turnouts". Sidewalks shall be constructed and paid for in accordance with Item, "Sidewalks".
34. Sidewalk details are shown elsewhere in the plans.

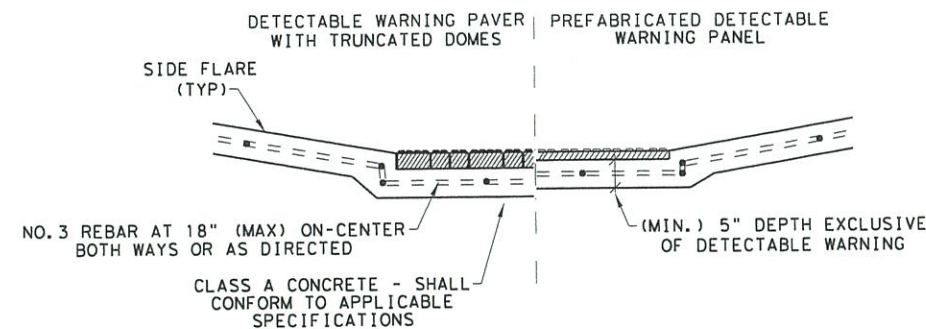

SECTION VIEW DETAIL
CURB RAMP AT DETECTIBLE WARNINGS

DETECTABLE WARNING SURFACE DETAILS

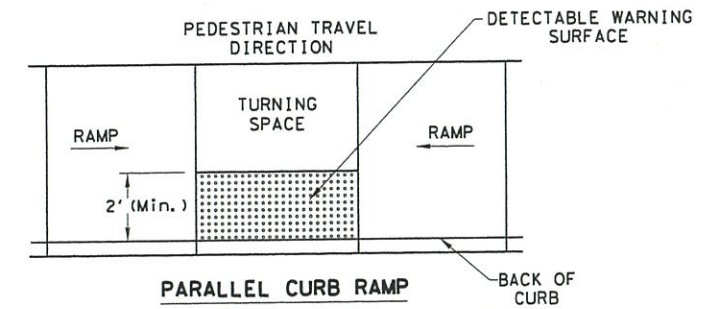

PARALLEL CURB RAMP
TYPICAL PLACEMENT OF DETECTABLE WARNING SURFACE ON LANDING AT STREET EDGE.

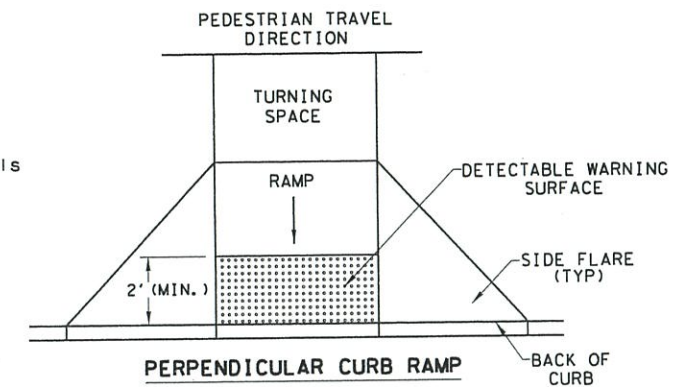

PERPENDICULAR CURB RAMP
TYPICAL PLACEMENT OF DETECTABLE WARNING SURFACE ON SLOPING RAMP RUN.

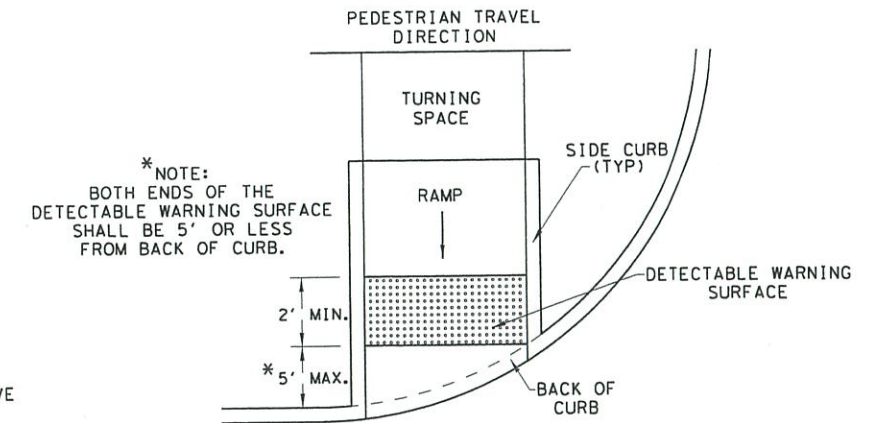

DIRECTIONAL CURB RAMP
TYPICAL PLACEMENT OF DETECTABLE WARNING SURFACE ON SLOPING RAMP RUN.

SHEET 2 OF 4

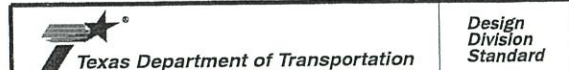

PEDESTRIAN FACILITIES CURB RAMPS

PED-18